

Your **NEW** recycling service



- What's new • What you should recycle
- Your containers • Find out more inside

What can be recycled using this **NEW** service?

Your NEW recycling service.

Food waste bin or on-street container



Kitchen caddy

For all types of cooked and uncooked food waste

Blue bin or blue lidded container



For paper, cardboard, metal and plastic containers

Burgundy bin or burgundy lidded container



For all colours of glass bottles and jars

Grey bin or black lidded container



For any household waste that cannot be recycled

We have introduced a new recycling service making it easier for you to recycle more material from your home.

Please check the letter enclosed with this leaflet as it has important information on the specific changes to your service.

Please check the enclosed letter which explains the type of service your property will receive.

The following pages explain HOW to use your recycling containers.



Collected every WEEK

Your **NEW** Food waste service

For all types of cooked and uncooked food waste

Top tip

All cooked and uncooked food waste can go into your kitchen caddy. This includes out of date food.



1 Line your caddy with one of the liners provided or with a plastic or compostable bag.



2 Put all cooked and uncooked food waste (including bones) into your kitchen caddy.



3 When the liner is almost full, tie and remove it from the kitchen caddy and replace with a new liner.



4 Lift the small lid on the top of your communal food waste bin and place the liner inside.



5 We will collect your communal food waste bin from the area your bin is stored every week.



6 We will empty your communal bin into the food waste recycling vehicle and return it to the storage area afterwards.

YES ✓

- ✓ Breads, cakes and pastries
- ✓ Eggs - including shells
- ✓ Fish - cooked and raw, including bones, skin and shells
- ✓ Fruit and vegetables - cooked and raw, including cores and peelings
- ✓ Pet food - wet and dry
- ✓ Rice, pasta and beans
- ✓ Tea bags and coffee grounds
- ✓ Hard fats and lard
- ✓ Meat - cooked and raw, including fat, skin and bones

NO ✗

- ✗ Food packaging such as cardboard, plastic wrapping, tins
- ✗ Garden waste
- ✗ Liquids or oils
- ✗ Straw or other animal bedding products
- ✗ Pet waste

Top tip

You can buy compostable liners from all major supermarkets or, alternatively, line your caddy with plastic bags or newspaper. **Please do NOT use black bags to line your caddy.**



Collected every **TWO WEEKS**

Blue bin or blue lidded container

For paper, cardboard, metals and plastics



1 Collect your materials for recycling.



2 Rinse and squash your cans, plastic containers and plastic bottles.



3 Flatten your cardboard.



4 Place your cans, paper, cardboard, plastic bottles and containers and food and drinks cartons into your blue or blue lidded recycling bin.



5 We will collect your communal blue or blue lidded bin from the area your bin is stored every 2 weeks.

YES ✓

Paper

- ✓ Newspapers
- ✓ Magazines
- ✓ Unwanted mail
- ✓ Telephone directories
- ✓ Greetings cards

Metals

- ✓ Steel food and drinks tins
- ✓ Aluminium cans
- ✓ Metal lids
- ✓ Foil trays

Cardboard

- ✓ Food packaging
- ✓ Cardboard boxes
- ✓ Egg boxes
- ✓ Toilet and kitchen roll tubes

Plastic bottles and containers

- ✓ Drinks bottles
- ✓ Food trays
- ✓ Milk bottles
- ✓ Yoghurt pots

Cardboard food and drinks cartons

- ✓ Soup, milk and juice cartons

NO ✗

- ✗ Glass
- ✗ Food waste
- ✗ Nappies
- ✗ Polystyrene
- ✗ Household rubbish
- ✗ CDs and DVDs
- ✗ Plastic film
- ✗ Plastic bags
- ✗ Black plastic food trays

Top tip

Clean plastic bottle tops, foil trays and metal lids can also be recycled.



Collected
every
FOUR
WEEKS

Burgundy bin or burgundy lidded container

For all types of glass bottles and jars



1 Remove any lids from glass containers.



2 Rinse your glass containers out.



3 Place your glass bottles and jars into your burgundy or burgundy lidded communal recycling bin.

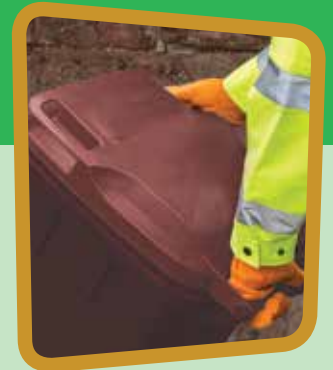

4 We will collect your burgundy or red lidded bin from the area your bin is stored every 4 weeks.

YES ✓

Glass (lids removed)

- ✓ Wine bottles
- ✓ Beer bottles
- ✓ Juice bottles
- ✓ Cooking sauce jars
- ✓ Jam jars
- ✓ Baby food jars
- ✓ Sauce bottles

NO ✗

- ✗ Pyrex
- ✗ Window or sheet glass
- ✗ Crockery or drinking glasses
- ✗ Plastic bags
- ✗ Plastic bottles or containers
- ✗ Food tins or drinks cans

Top tip

Metal lids from your glass bottles and jars can go in your blue bin.

What can I put in my caddy?



Kitchen caddy

YES ✓

- ✓ Leftovers from meals
- ✓ Leftovers from preparation
- ✓ Out of date food left in fridge or cupboards

Types of food



Dairy ✓



Meat and bones ✓



Fruit ✓



Vegetables ✓



Bread ✓



Rice and pasta ✓



Fish ✓



Tea bags and coffee grounds ✓

Your new food waste recycling service will be able to be used for **ALL cooked** ✓ and **uncooked** ✓ food waste, it will even take bones!

Top tip

Remember to recycle all food packaging in your blue or burgundy bin wherever possible.

Where can I get more liners?

You can buy compostable caddy liners in all major supermarkets. Alternatively, you can use plastic bags or newspaper to line your caddy.

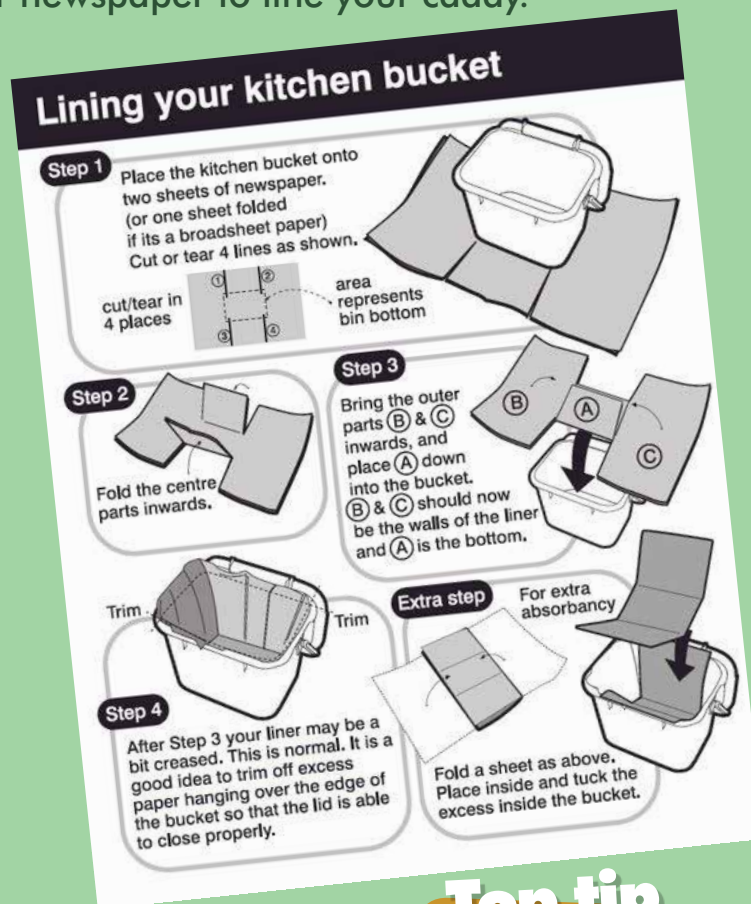

Top tip

Please don't use black bags to line your caddy, as these make it difficult for the crews to check caddies at the kerbside.



Collected every **TWO WEEKS**

Grey bin or black lidded container

For household waste that can't be recycled



1 Please collect your materials that cannot be recycled and place in your grey or communal black lidded bin.

2 We will collect your grey/black lidded bin from the area your bins are stored on your collection day and we will return it to your storage area for you.

What happens to the materials I recycle?

The materials we collect from your blue and burgundy bins are taken to special processing plants where they are recycled and turned into valuable new resources such as new bottles, cans and newspapers.



Your food waste is taken to a special processing plant where it is recycled and turned into valuable resources such as agricultural fertiliser and energy.



Information kindly provided by Scottish Water Horizons

www.dundee.gov.uk/recyclefordundee

✉ recycle@dundee.gov.uk ☎ 01382 434300/434303

www.dundee.gov.uk/recyclefordundee

✉ recycle@dundee.gov.uk ☎ 01382 434300/434303

Frequently Asked Questions

Q: Why is this new recycling service being introduced?

A: Recycling has never been more important and these changes are designed to improve and enhance the existing collection framework as well as allowing us to expand our recycling services city-wide. By introducing these services we hope to achieve the boost in recycling required to meet the Scottish Government's targets for recycling whilst also complying with recent regulation on recycling provision.

Q: Why is my waste collection service changing to once a fortnight?

A: Not every communal grey or black lidded bin will be collected fortnightly - some will have more frequent collections, if this is necessary. You should continue to use your food waste, blue and burgundy bins to recycle as much material as possible.

Q: What if I have extra waste that won't fit in the bin?

A: If you have extra waste or recycling you can take it, free of charge, to one of Dundee's recycling centres at Baldovie and Riverside. You can also recycle more types of material at these centres such as electrical items, scrap metal and textiles, as well as donating items to the Re-use Hub at Baldovie. Extra waste should not be left at the side of bins.

Why should I use the new food waste collection service?

A: Food waste is a valuable resource which can be recycled to generate real environmental benefits such as renewable heat & energy as well as nutrient rich fertiliser.

www.dundee.gov.uk/recyclefordundee

✉ recycle@dundee.gov.uk ☎ 01382 434300/434303

More FAQs are available on our website:

www.dundee.gov.uk/recyclefordundee

✉ recycle@dundee.gov.uk ☎ 01382 434300/434303

Your household waste recycling centres

Dundee has two recycling centres to allow residents to recycle a wide range of materials and dispose of excess household waste.

Please ensure that all recyclable material is separated before you visit the site. Staff are on site to offer advice and direct you to the correct container.

Unwanted furniture and other household items which can be repaired can also be donated for re-use at the Re-Use Hub at Baldovie Recycling Centre.



Locations

Baldovie Recycling Centre
Piper Street
Dundee
DD4 0NT

Riverside Recycling Centre
Wright Avenue
Dundee
DD2 1UR

Opening times may vary during Summer and Winter months. Please check opening times for your nearest Recycling Centre by contacting:

 www.dundee.gov.uk/recyclefordundee

 recycle@dundeecity.gov.uk

 01382 434300/434303

This information is made available in large print or in an alternative format that meets your needs.

| | |
|----------------------------|--|
| Chinese | 欲知詳情，請致電：01382 435825 |
| Russian | Более подробную информацию можно получить позвонив по телефону: 01382 435825 |
| Urdu | مزید معلومات کے لئے براہ مہربانی 01382 435825 پر فون کریں۔ |
| Polish | po dalszą informację zadzwoń pod numer 01382 435825 |
| Alternative Formats | For further information please contact the issuer of this publication |