

- Legend**
- Proposed New Kerb Line
  - Proposed New Footway (including traffic islands)
  - Proposed New Carriageway (including removal of traffic islands)
  - Proposed New Greenspace
  - Proposed Segregated Cycle Lane

Rev	Rev Date	Purpose of revision	Des'd	Check'd	Rev'd	Appr'd

<b>Jacobs</b> 95 Bothwell St, Glasgow, G2 7HX Tel: +44(0)141 243 8000 Fax: +44(0)141 226 3109 www.jacobs.com						
Client <b>DUNDEE CITY COUNCIL</b>						
Project <b>EDEN PROJECT DUNDEE TRAVEL CONNECTIONS</b>						
Drawing title <b>MASTER DRAWING CONCEPT DESIGN</b>						
Drawing status <b>FINAL CONCEPT</b>						
Scale	1:2000	@A1	Rev			
Jacobs No.	B2494600					
Drawing number	B2494600-CD-MD-01					

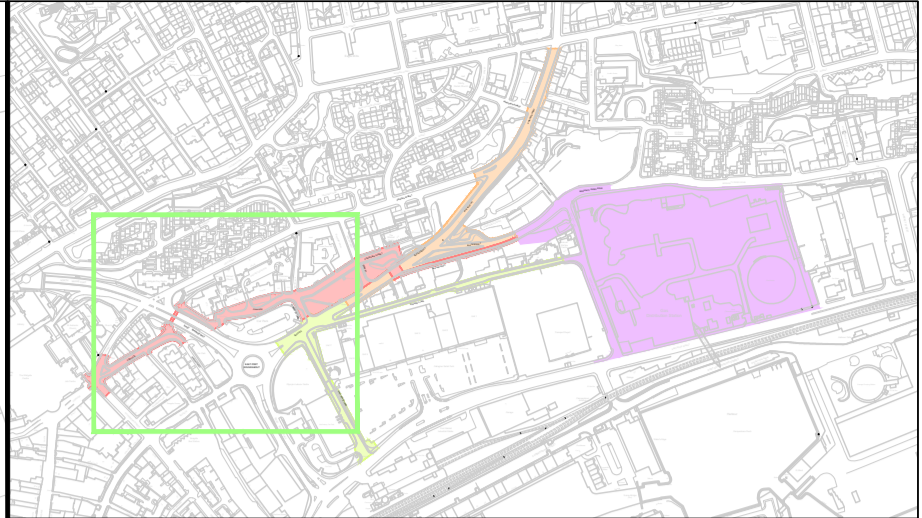
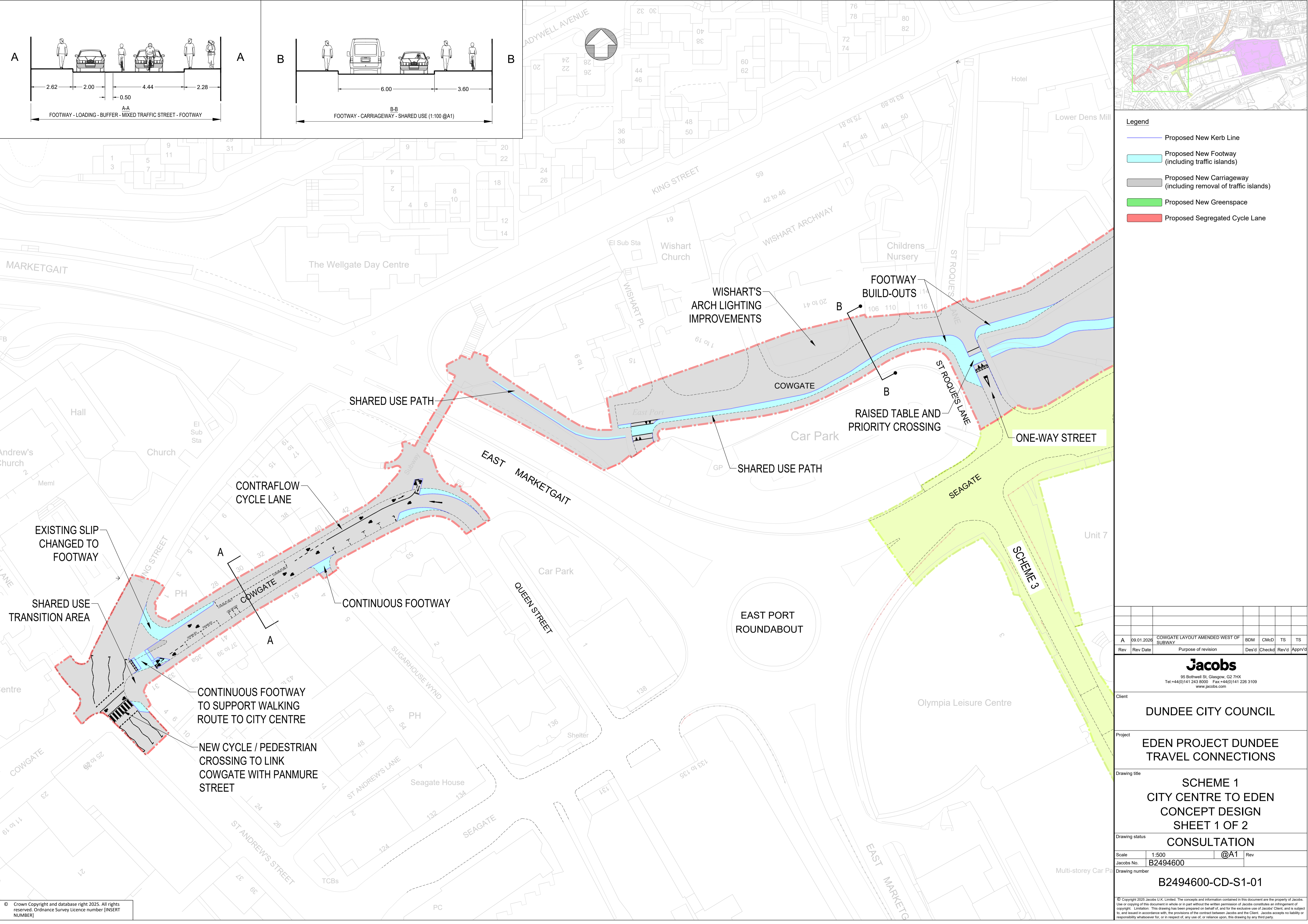
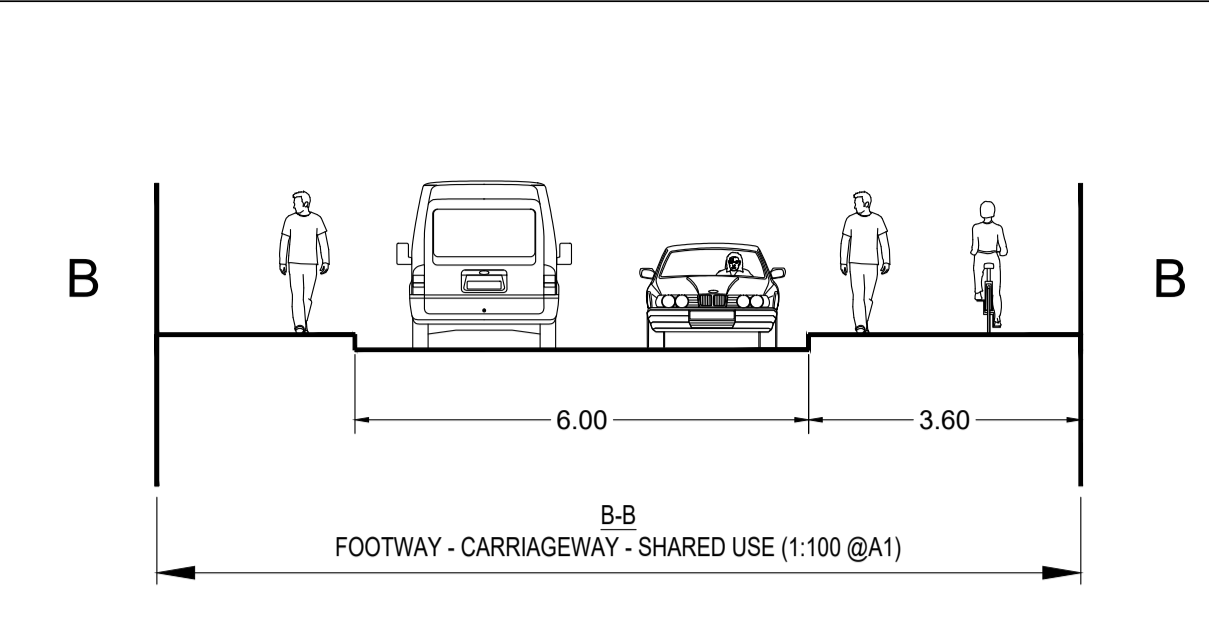
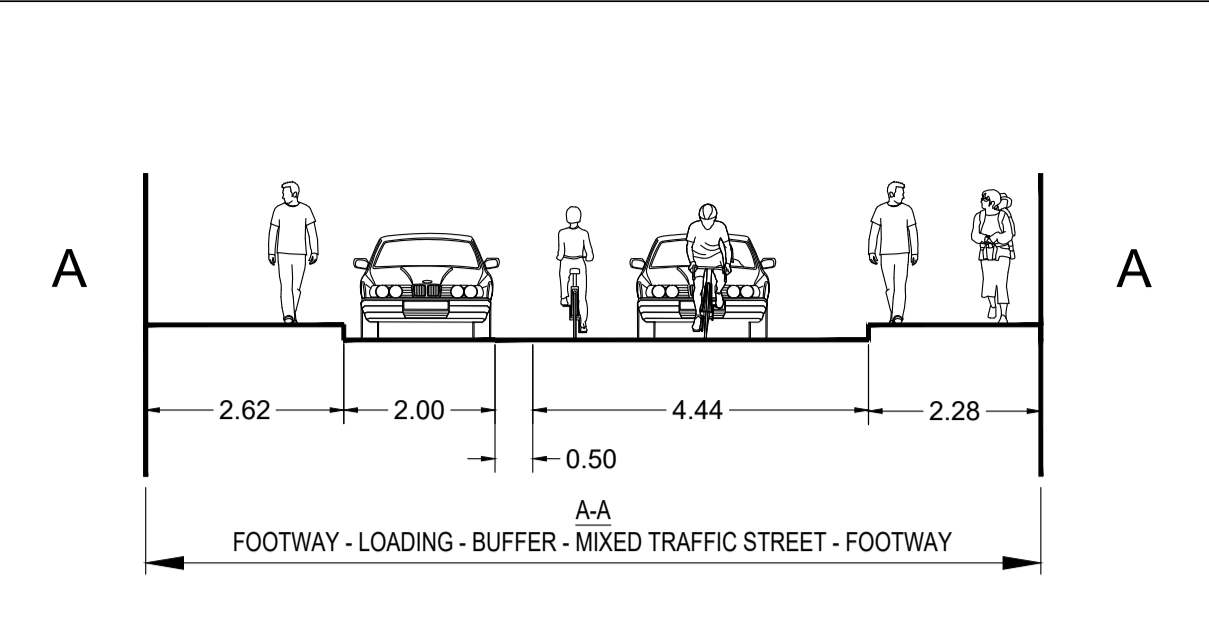

- Legend**
- Proposed New Kerb Line
  - Proposed New Footway (including traffic islands)
  - Proposed New Carriageway (including removal of traffic islands)
  - Proposed New Greenspace
  - Proposed Segregated Cycle Lane

Rev	Rev Date	Purpose of revision	Des'd	Check'd	Rev'd	Apprv'd
A	09.01.2026	COWGATE LAYOUT AMENDED WEST OF SUBWAY	BDM	CMdD	TS	TS

**Jacobs**  
 95 Bothwell St, Glasgow, G2 7HX  
 Tel: +44(0)141 243 8000 Fax: +44(0)141 226 3109  
 www.jacobs.com

Client  
**DUNDEE CITY COUNCIL**

Project  
**EDEN PROJECT DUNDEE TRAVEL CONNECTIONS**

Drawing title  
**SCHEME 1 CITY CENTRE TO EDEN CONCEPT DESIGN SHEET 1 OF 2**

Drawing status  
**CONSULTATION**

Scale  
 1:500 @A1 Rev

Jacobs No.  
 B2494600

Drawing number  
 B2494600-CD-S1-01

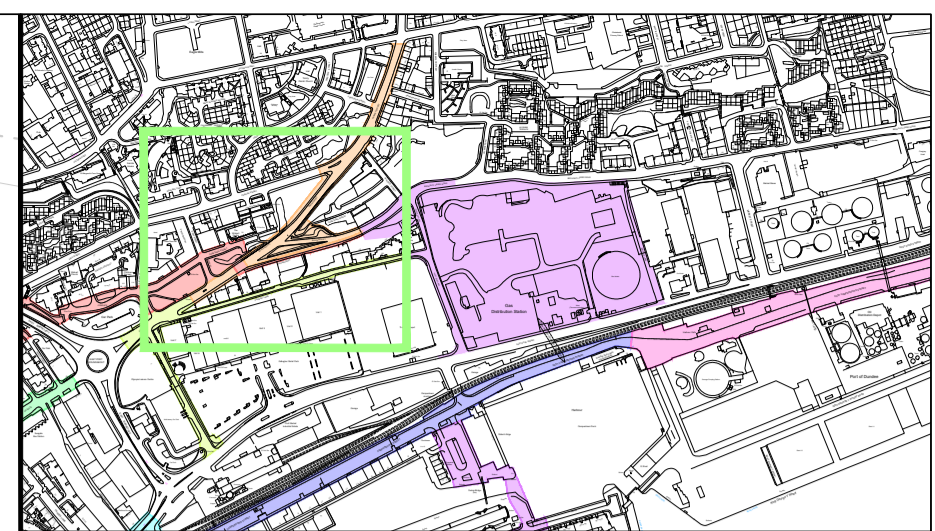
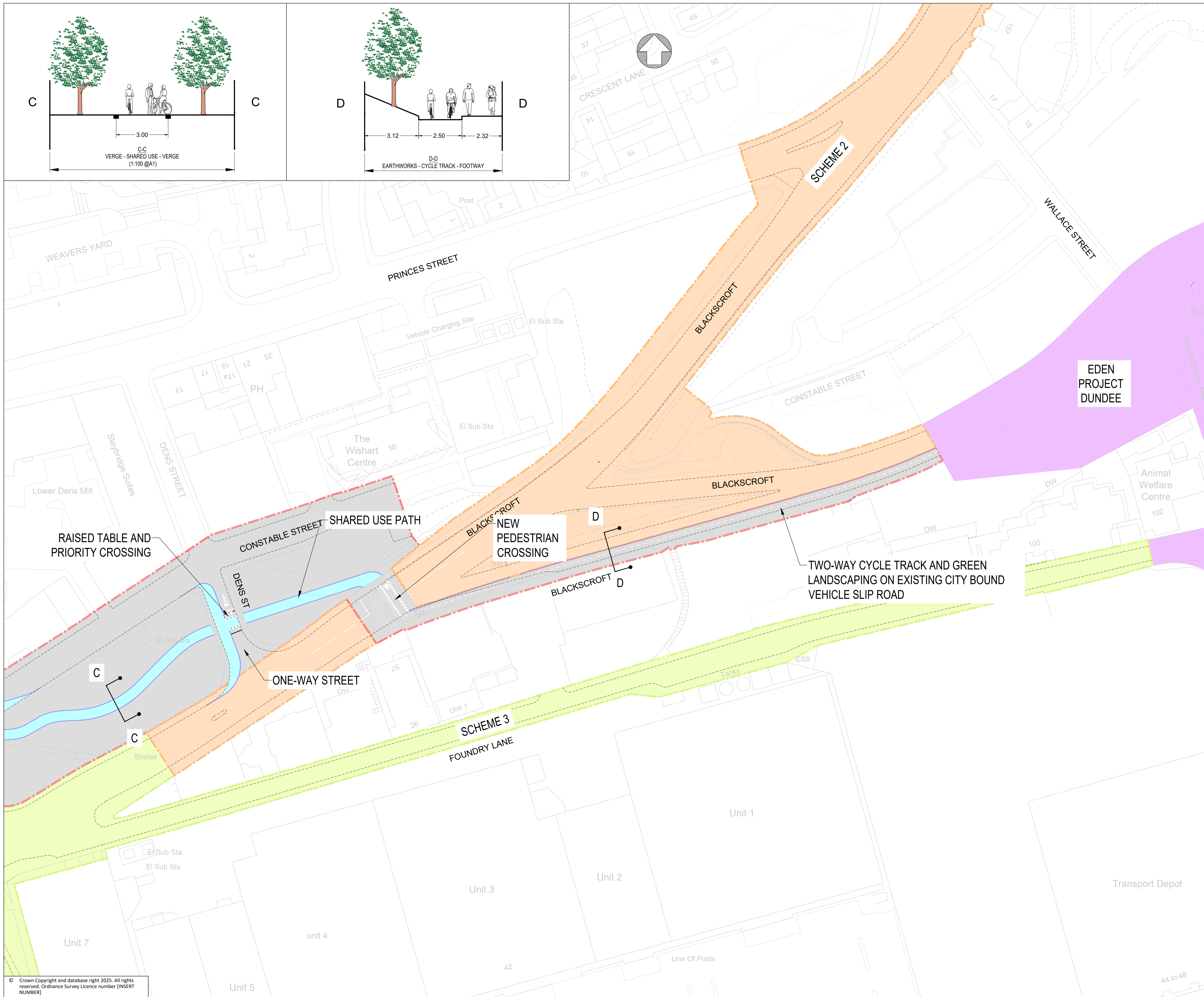
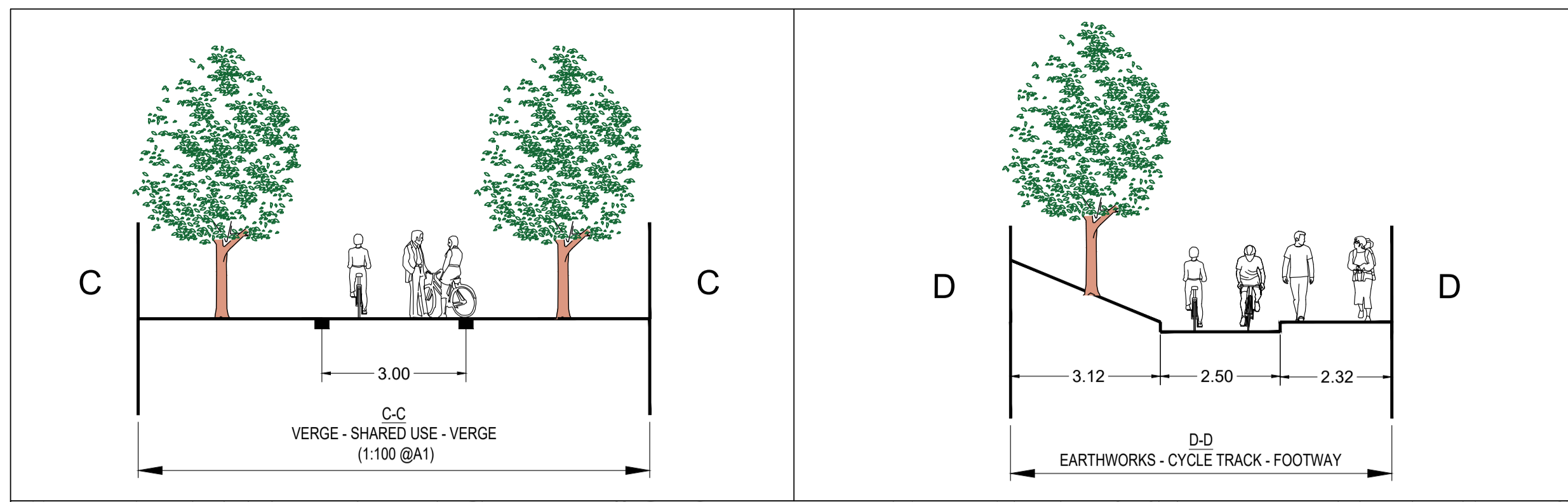

- Legend**
- Proposed New Kerb Line
  - Proposed New Footway (including traffic islands)
  - Proposed New Carriageway (including removal of traffic islands)
  - Proposed New Greenspace
  - Proposed Segregated Cycle Lane

Rev	Rev Date	Purpose of revision	Des'd	Check'd	Rev'd	Appr'd

**Jacobs**  
 95 Bothwell St, Glasgow, G2 7HX  
 Tel: +44(0)141 243 8000 Fax: +44(0)141 226 3109  
 www.jacobs.com

Client: **DUNDEE CITY COUNCIL**

Project: **EDEN PROJECT DUNDEE TRAVEL CONNECTIONS**

Drawing title: **SCHEME 1 CITY CENTRE TO EDEN CONCEPT DESIGN SHEET 2 OF 2**

Drawing status: **FINAL CONCEPT**

Scale: 1:500 @A1 Rev

Jacobs No. B2494600

Drawing number: **B2494600-CD-S1-02**

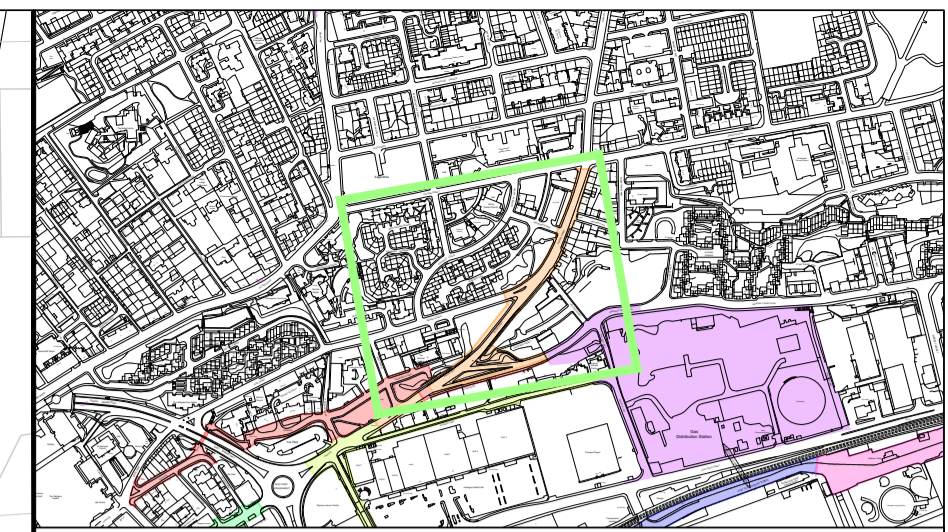
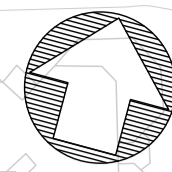
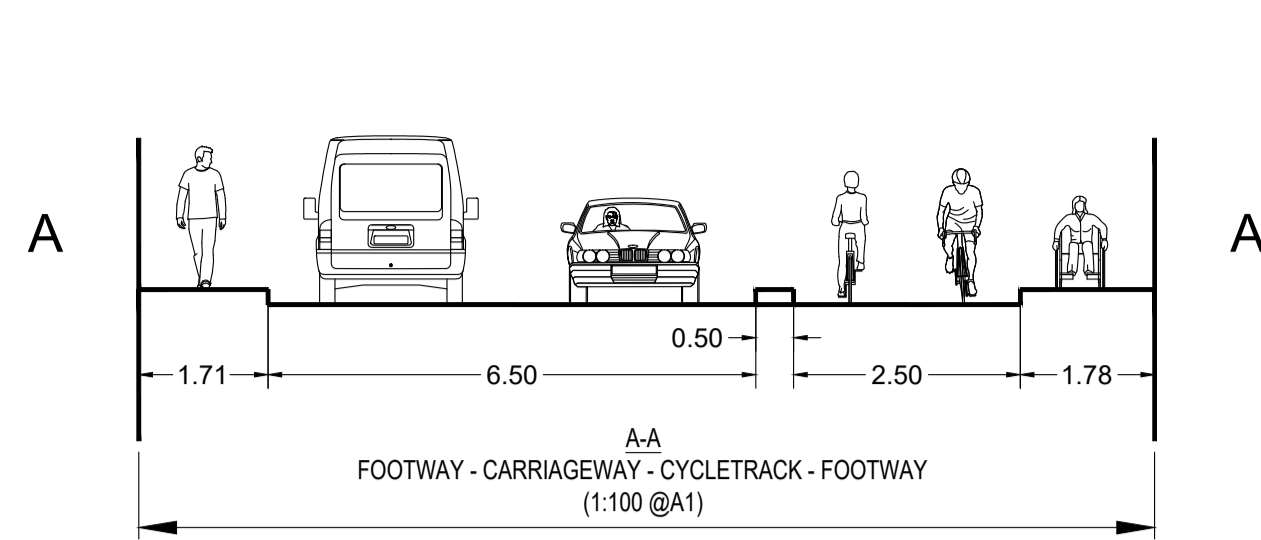

Legend

- Proposed New Kerb Line
- Proposed New Footway (including traffic islands)
- Proposed New Carriageway (including removal of traffic islands)
- Proposed New Greenspace
- Proposed Segregated Cycle Lane

PRINCES STREET PROPOSALS WILL NEED TO CONNECT TO ARBROATH SUSTAINABLE TRANSPORT CORRIDOR

BUS STOP BYPASS ARRANGEMENT

LAYBY REMOVED

NEW TOUCAN CROSSING

SHARED-USE TRANSITION FOOTWAY

TIGHTENED JUNCTION AND REMOVAL OF ISLAND

NEW FOOTWAY FORMED TO REAR OF LINE OF TREES / GRASS VERGE

CARRIAGEWAY WIDENED INTO EXISTING FOOTWAY SPACE

EXISTING TREES PRESERVED IN NEWLY CREATED GRASS VERGE

TIGHTEN JUNCTION RADII AND REMOVE RIGHT TURN POCKET

RAISED TABLE AND PRIORITY CROSSING

EDEN PROJECT DUNDEE

Rev	Rev Date	Purpose of revision	Des'd	Check'd	Rev'd	Apprv'd

**Jacobs**

95 Bothwell St, Glasgow, G2 7HX  
Tel: +44(0)141 243 8000 Fax: +44(0)141 226 3109  
www.jacobs.com

Client

DUNDEE CITY COUNCIL

Project

EDEN PROJECT DUNDEE TRAVEL CONNECTIONS

Drawing title

SCHEME 2  
ARBROATH ROAD TO EDEN  
CONCEPT DESIGN  
SHEET 1 OF 1

Drawing status

FINAL CONCEPT

Scale

1:500 @A1 Rev

Jacobs No.

B2494600

Drawing number

B2494600-CD-S2-01

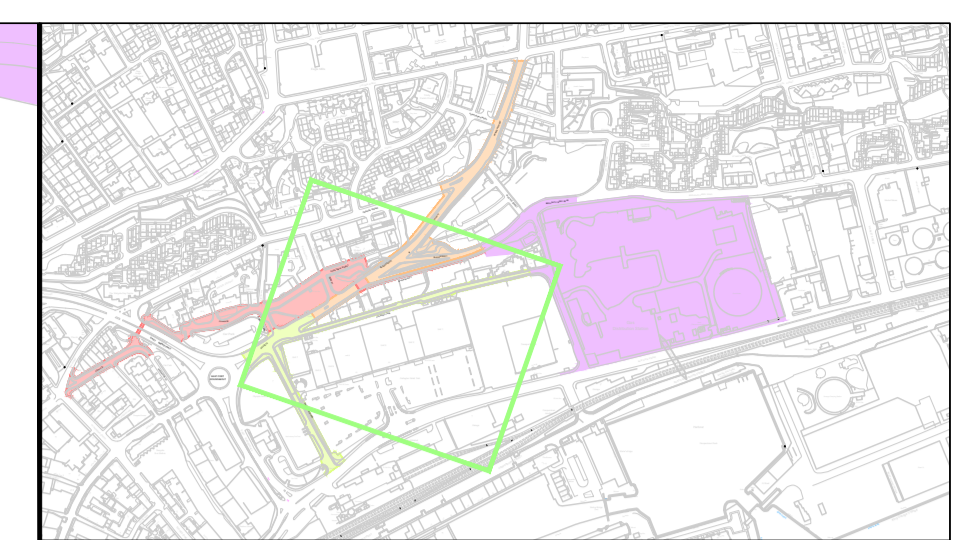
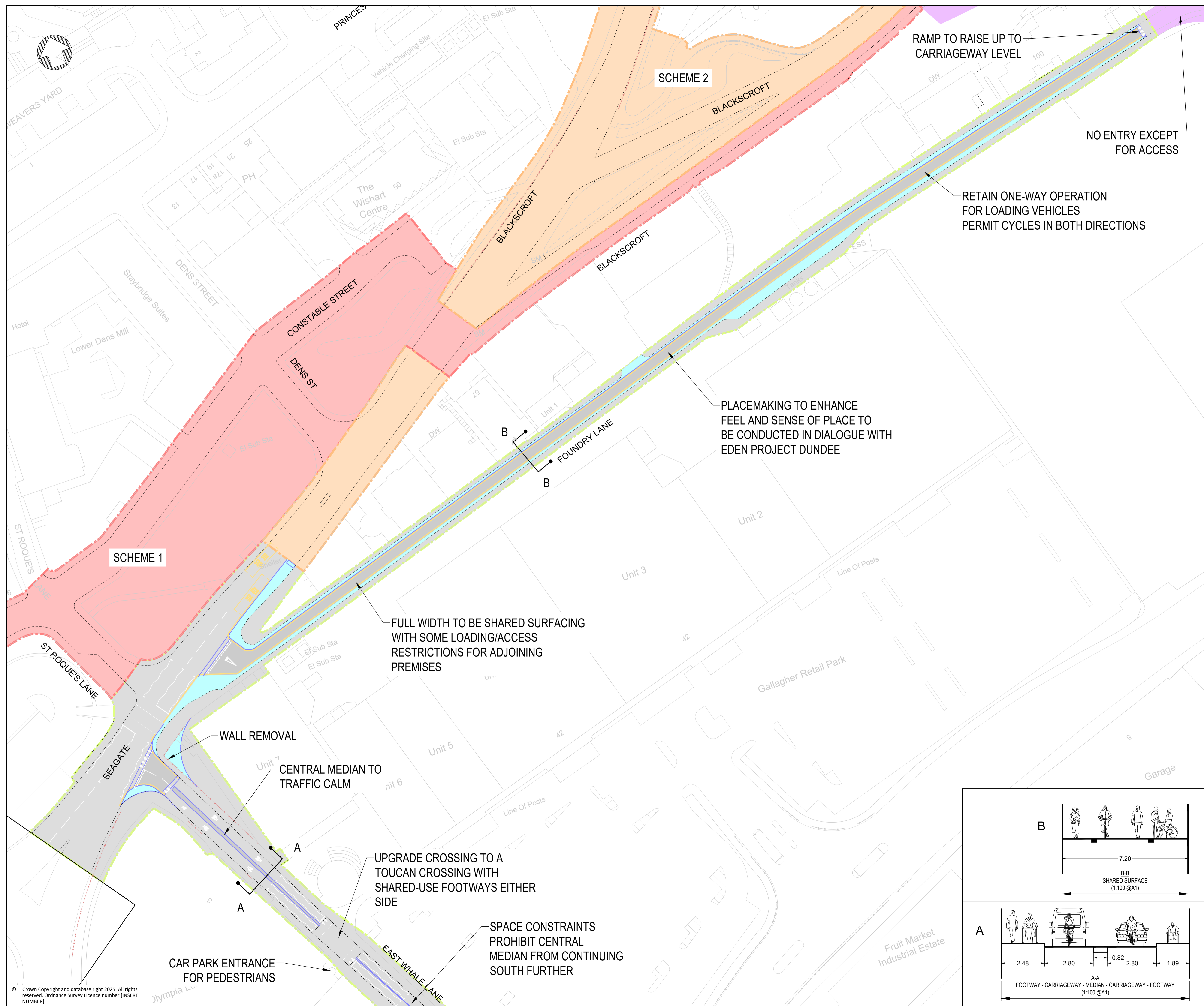

- Legend**
- Proposed New Kerb Line
  - Proposed New Footway (including traffic islands)
  - Proposed New Carriageway (including removal of traffic islands)
  - Proposed New Greenspace
  - Proposed Segregated Cycle Lane

Rev	Rev Date	Purpose of revision	Des'd	Check'd	Rev'd	Appr'd

**Jacobs**  
 95 Bothwell St, Glasgow, G2 7HX  
 Tel: +44(0)141 243 8000 Fax: +44(0)141 226 3109  
 www.jacobs.com

Client: **DUNDEE CITY COUNCIL**

Project: **EDEN PROJECT DUNDEE TRAVEL CONNECTIONS**

Drawing title: **SCHEME 3 OLYMPIA TO EDEN CONCEPT DESIGN SHEET 1 OF 1**

Drawing status: **CONSULTATION**

Scale: 1:500 @A1 Rev

Jacobs No. B2494600

Drawing number: **B2494600-CD-S3-01**

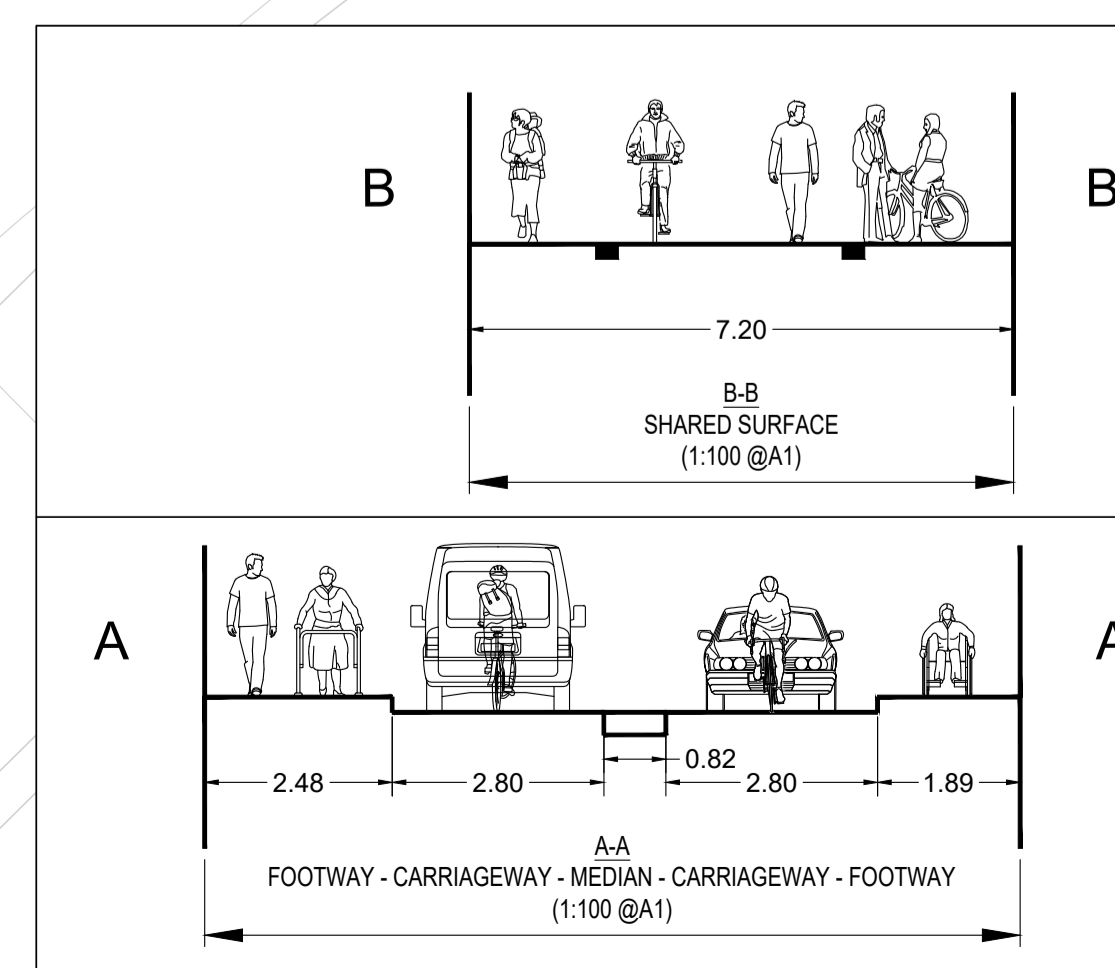

© Crown Copyright and database right 2025. All rights reserved. Ordnance Survey Licence number [INSERT NUMBER]

© Copyright 2025 Jacobs U.K. Limited. The concepts and information contained in this document are the property of Jacobs. Use or copying of this document in whole or in part without the written permission of Jacobs constitutes an infringement of copyright. Limitation: This drawing has been prepared on behalf of and for the exclusive use of Jacobs' Client, and is subject to, and issued in accordance with, the provisions of the contract between Jacobs and the Client. Jacobs accepts no liability or responsibility whatsoever for, or in respect of, any use of, or reliance upon, this drawing by any third party.

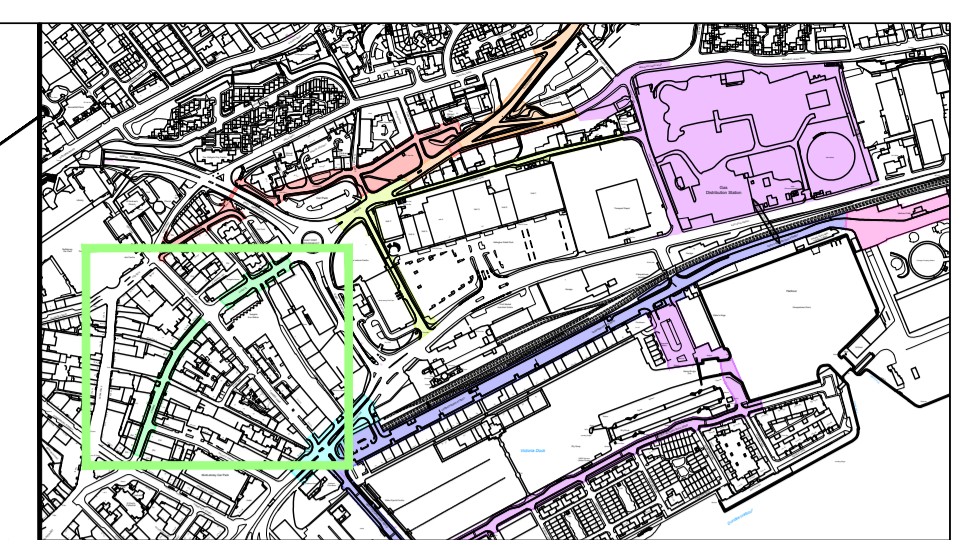
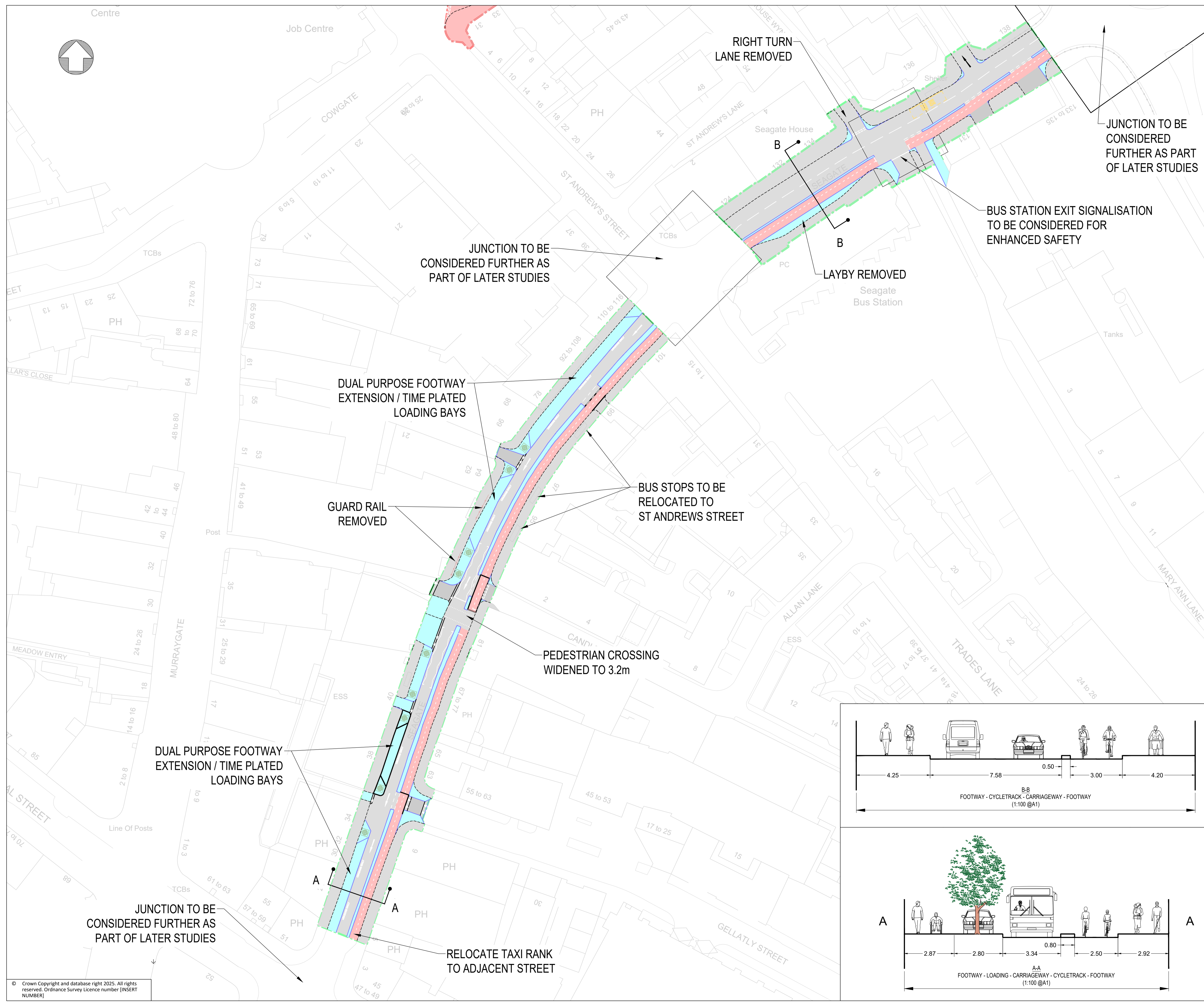
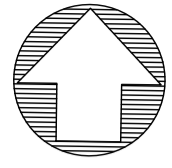

- Legend**
- Proposed New Kerb Line
  - Proposed New Footway (including traffic islands)
  - Proposed New Carriageway (including removal of traffic islands)
  - Proposed New Greenspace
  - Proposed Segregated Cycle Lane

Rev	Rev Date	Purpose of revision	Des'd	Check'd	Rev'd	Appr'd

**Jacobs**  
95 Bothwell St, Glasgow, G2 7HX  
Tel: +44(0)141 243 8000 Fax: +44(0)141 226 3109  
www.jacobs.com

Client  
**DUNDEE CITY COUNCIL**

Project  
**EDEN PROJECT DUNDEE TRAVEL CONNECTIONS**

Drawing title  
**SCHEME 4 SEAGATE CONCEPT DESIGN SHEET 1 OF 1**

Drawing status  
**FINAL CONCEPT**

Scale  
1:500 @A1 Rev

Jacobs No.  
B2494600

Drawing number  
**B2494600-CD-S4-01**

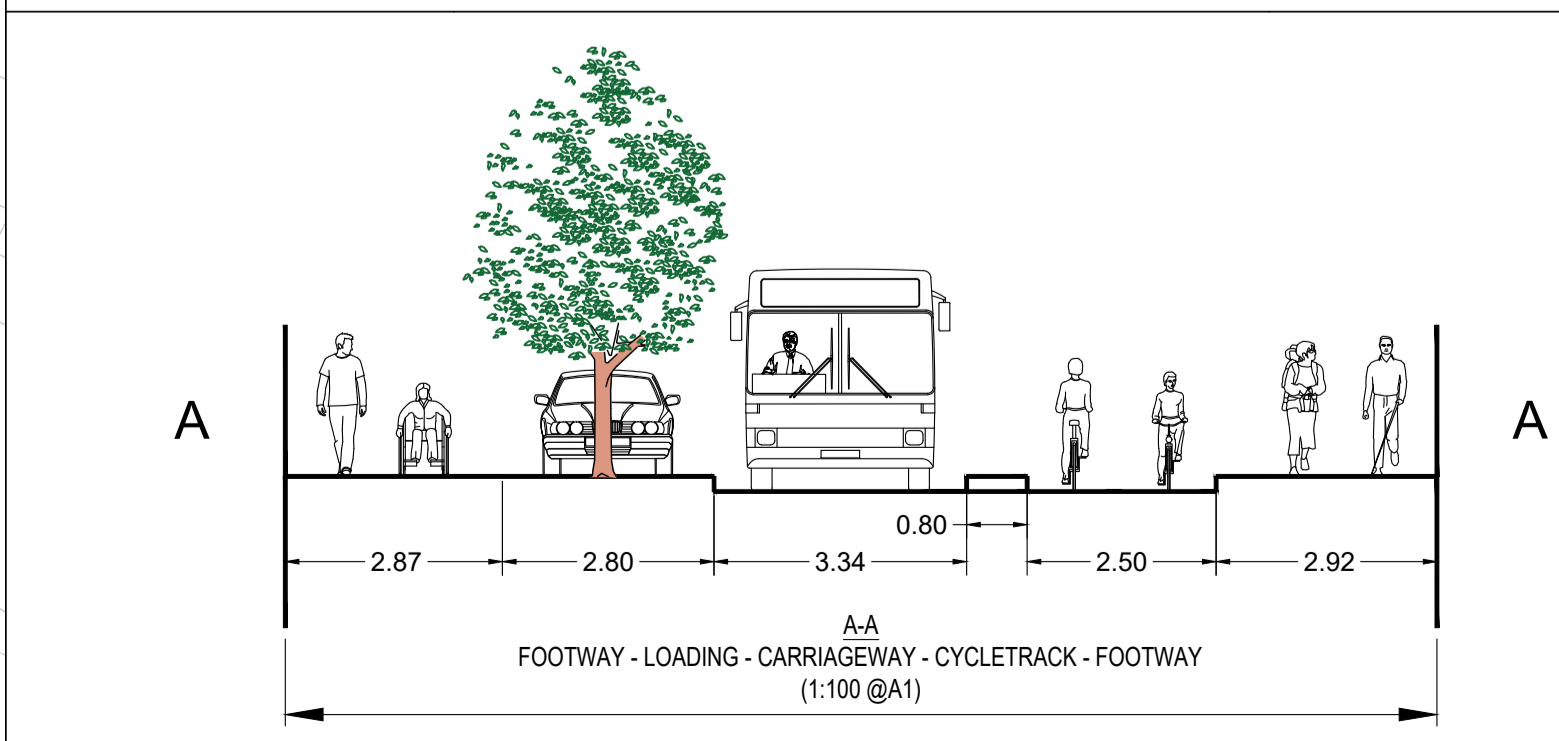
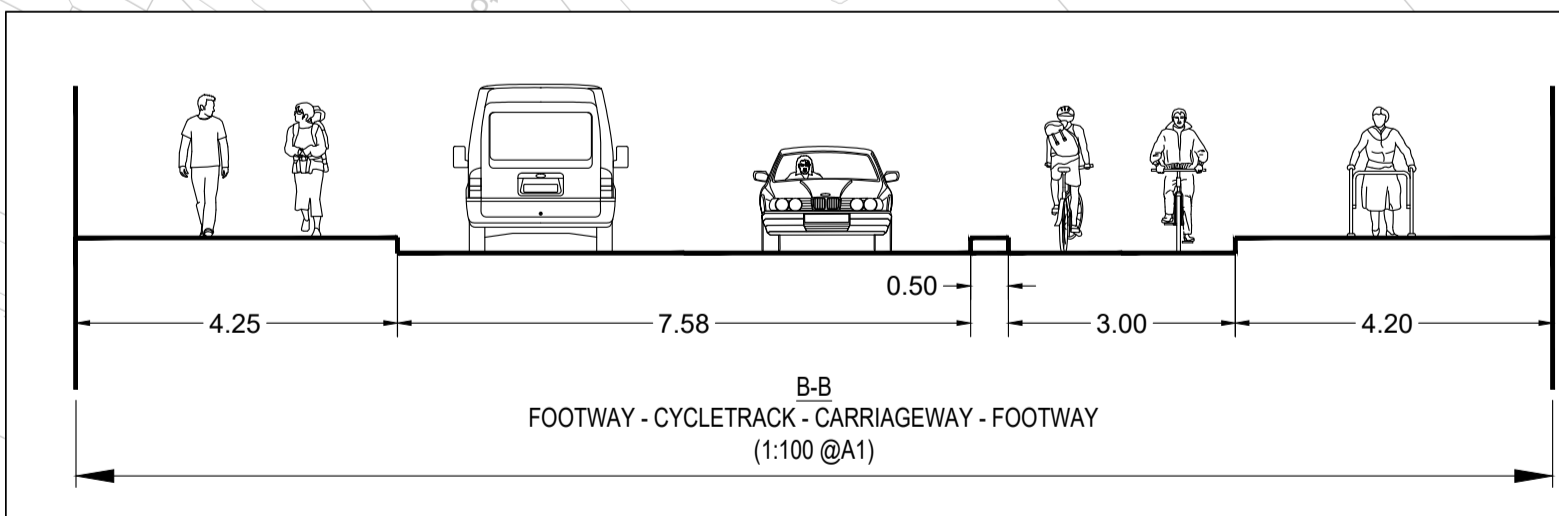

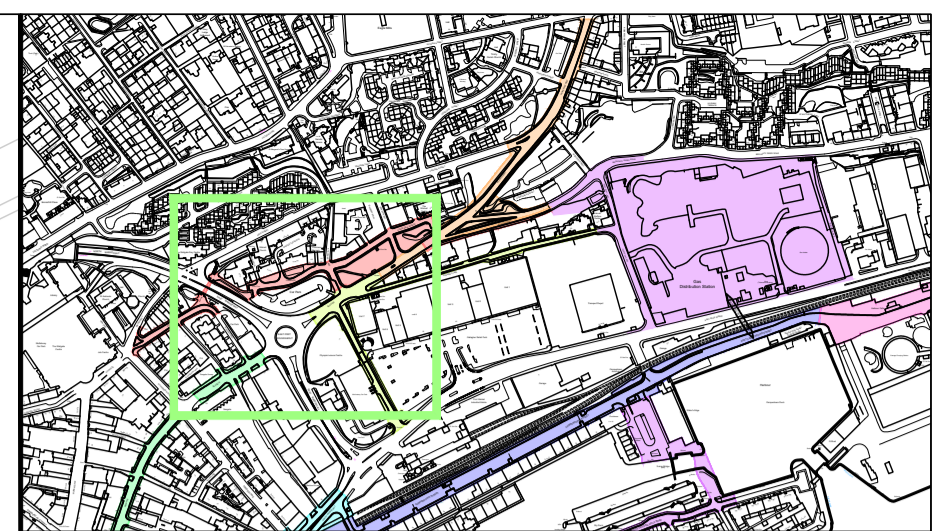
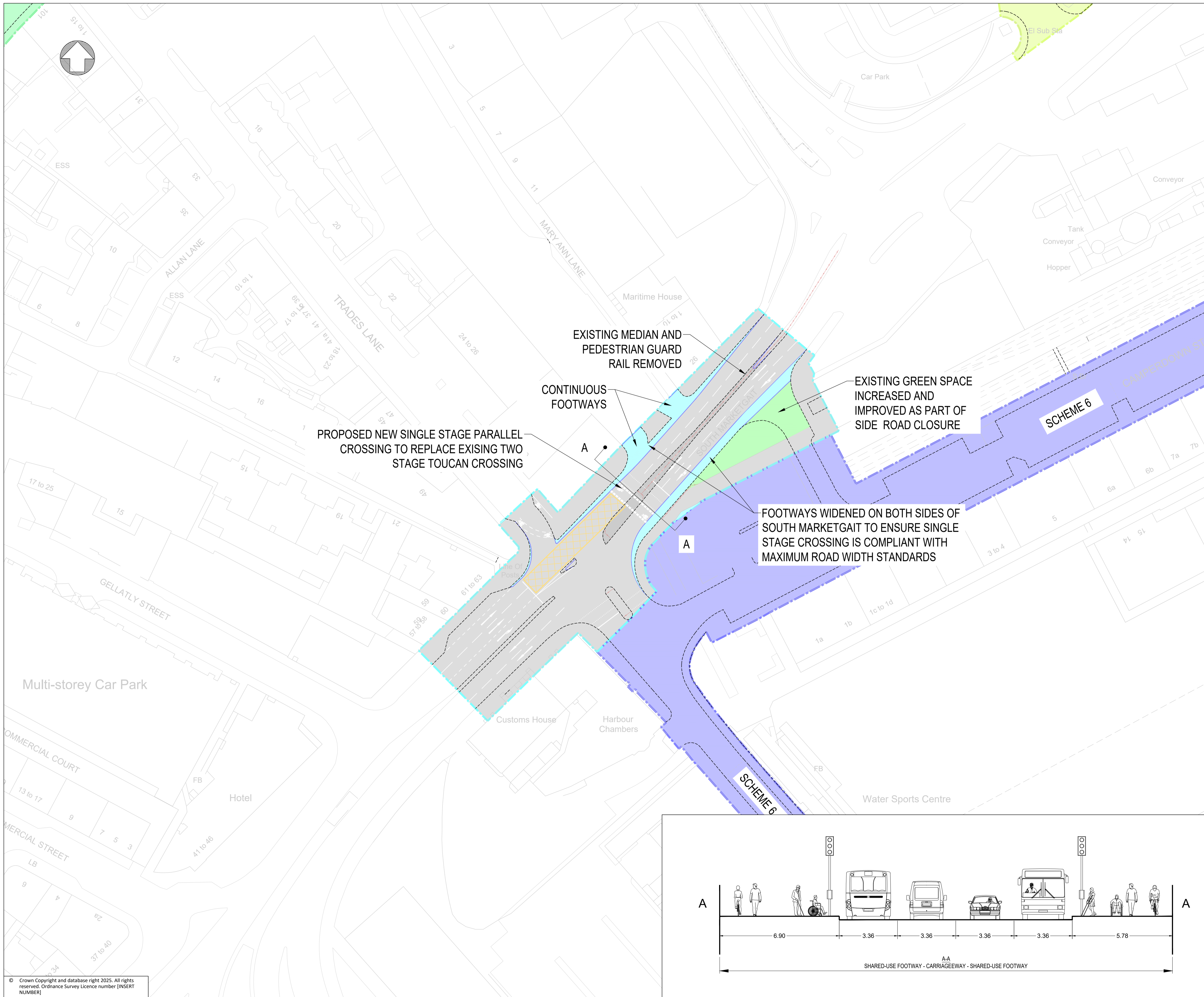

- Legend**
- Proposed New Kerb Line
  - Proposed New Footway (including traffic islands)
  - Proposed New Carriageway (including removal of traffic islands)
  - Proposed New Greenspace
  - Proposed Segregated Cycle Lane

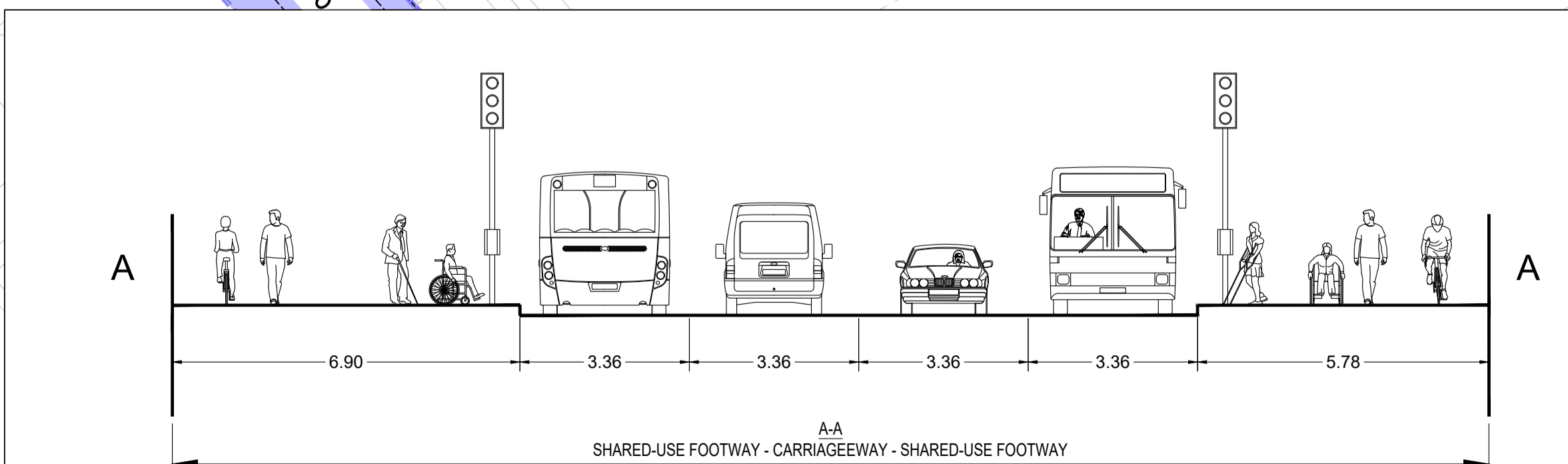

Rev	Rev Date	Purpose of revision	Des'd	Check'd	Rev'd	Appr'd

**Jacobs**  
 95 Bothwell St, Glasgow, G2 7HX  
 Tel: +44(0)141 243 8000 Fax: +44(0)141 226 3109  
 www.jacobs.com

Client  
**DUNDEE CITY COUNCIL**

Project  
**EDEN PROJECT DUNDEE TRAVEL CONNECTIONS**

Drawing title  
**SCHEME 5 DOCK STREET CROSSING CONCEPT DESIGN SHEET 1 OF 1**

Drawing status  
**FINAL CONCEPT**

Scale  
 1:500 @A1 Rev

Jacobs No.  
**B2494600**

Drawing number  
**B2494600-CD-S5-01**

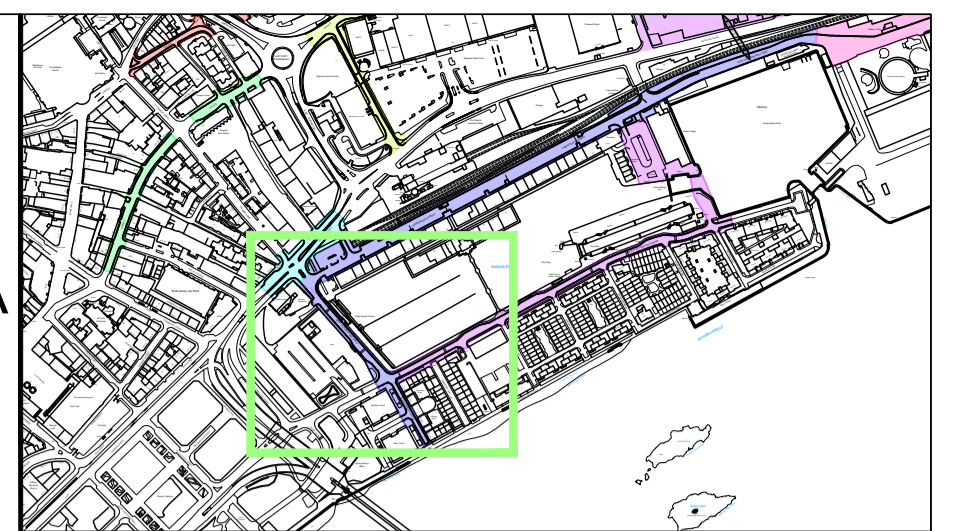
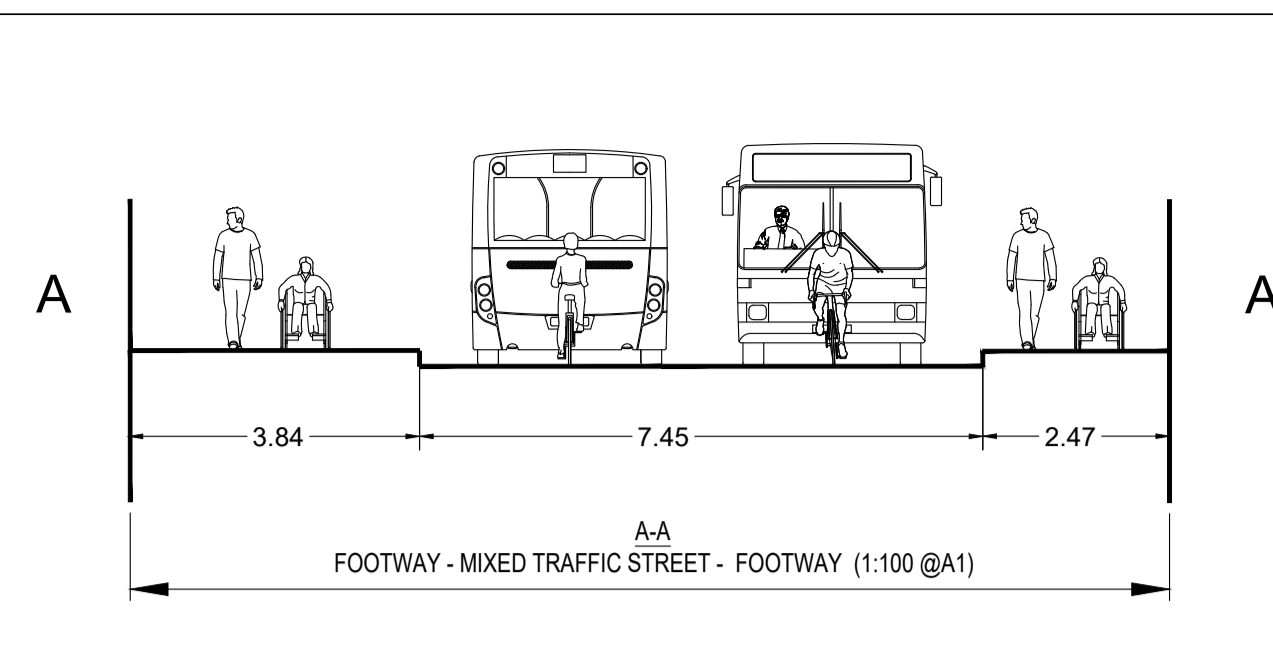
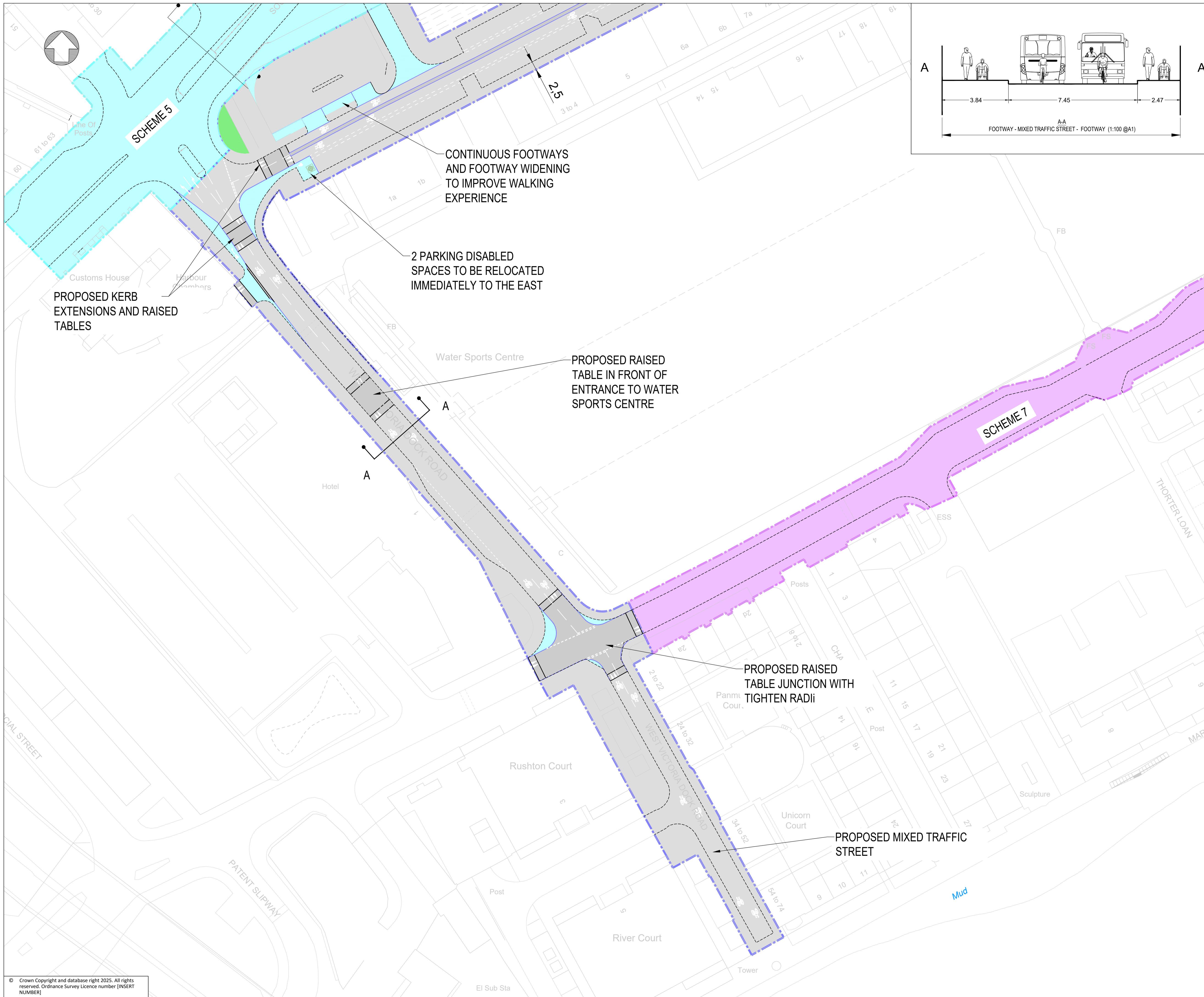

- Legend**
- Proposed New Kerb Line
  - Proposed New Footway (including traffic islands)
  - Proposed New Carriageway (including removal of traffic islands)
  - Proposed New Greenspace
  - Proposed Segregated Cycle Lane

Rev	Rev Date	Purpose of revision	Des'd	Check'd	Rev'd	Apprv'd

**Jacobs**  
 95 Bothwell St, Glasgow, G2 7HX  
 Tel: +44(0)141 243 8000 Fax: +44(0)141 226 3109  
 www.jacobs.com

Client  
**DUNDEE CITY COUNCIL**

Project  
**EDEN PROJECT DUNDEE TRAVEL CONNECTIONS**

Drawing title  
**SCHEME 6 WATERFRONT TO EDEN CONCEPT DESIGN FROM WEST - SHEET 1 OF 3**

Drawing status  
**FINAL CONCEPT**

Scale  
1:500 @A1 Rev

Jacobs No.  
B2494600

Drawing number  
B2494600-CD-S6-01

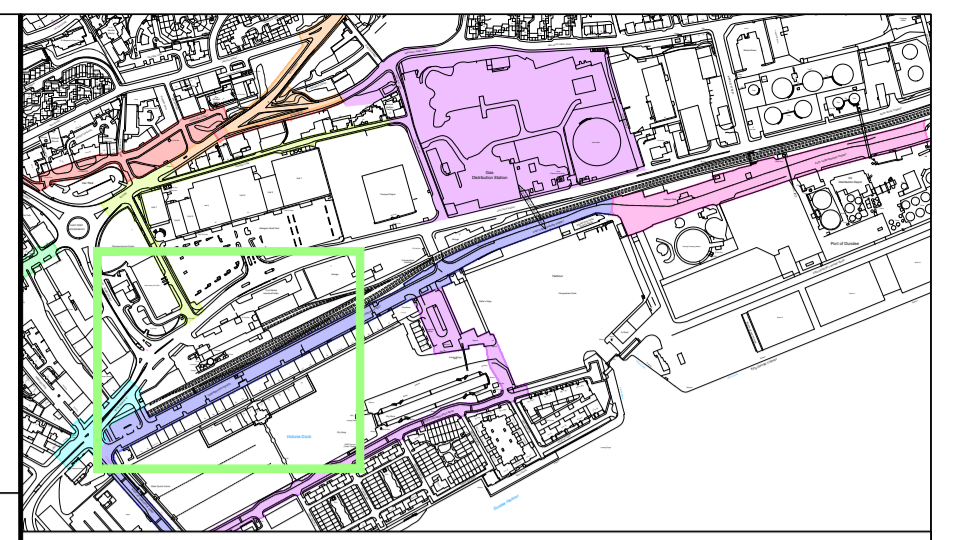
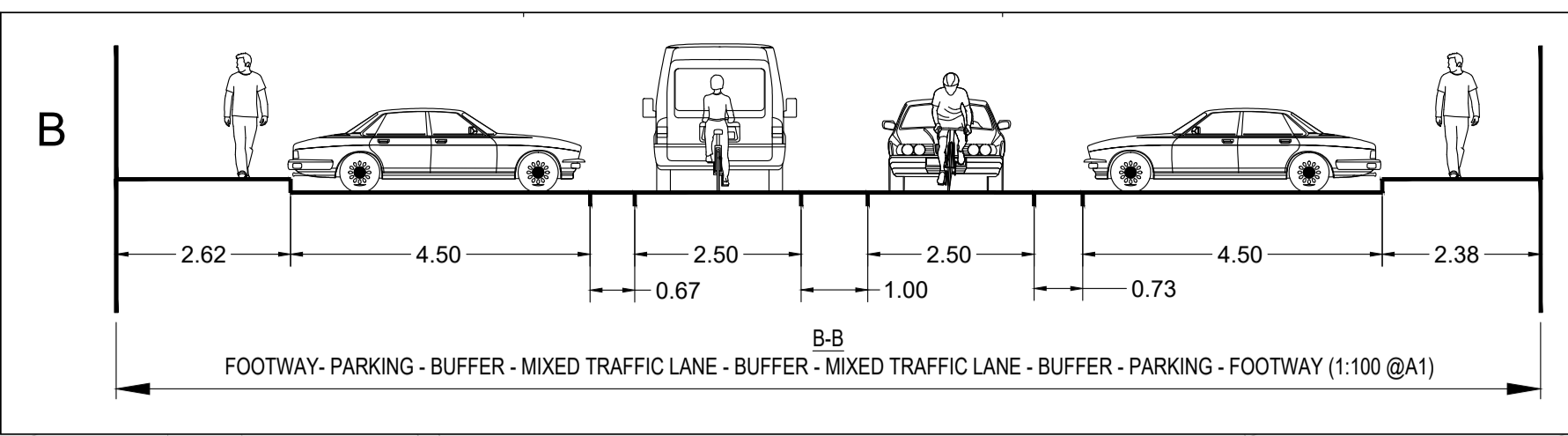
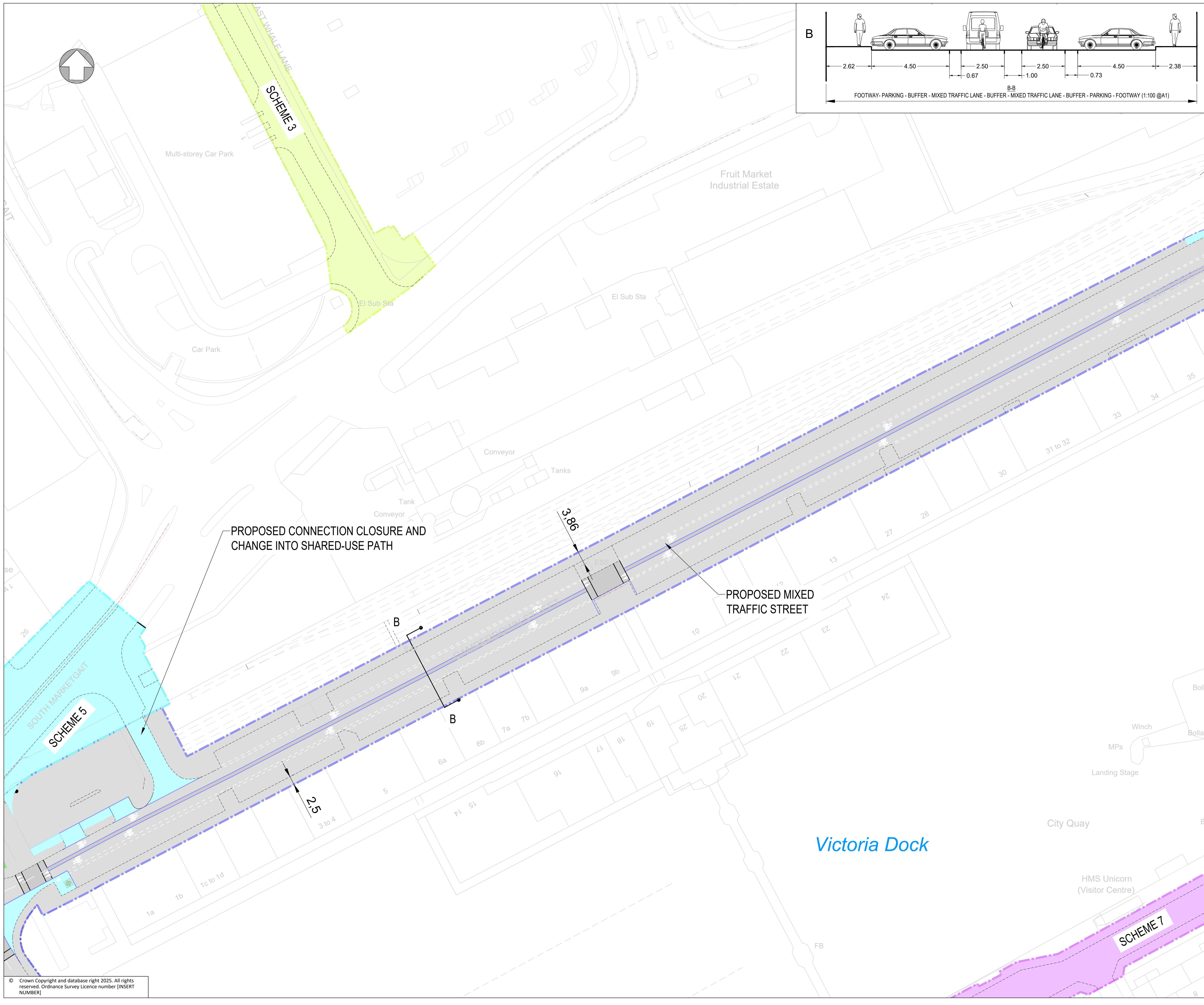

- Legend**
- Proposed New Kerb Line
  - Proposed New Footway (including traffic islands)
  - Proposed New Carriageway (including removal of traffic islands)
  - Proposed New Greenspace
  - Proposed Segregated Cycle Lane

Rev	Rev Date	Purpose of revision	Des'd	Check'd	Rev'd	Apprv'd

**Jacobs**  
 95 Bothwell St, Glasgow, G2 7HX  
 Tel: +44(0)141 243 8000 Fax: +44(0)141 226 3109  
 www.jacobs.com

Client  
**DUNDEE CITY COUNCIL**

Project  
**EDEN PROJECT DUNDEE TRAVEL CONNECTIONS**

Drawing title  
**SCHEME 6 WATERFRONT TO EDEN CONCEPT DESIGN FROM WEST - SHEET 2 OF 3**

Drawing status  
**FINAL CONCEPT**

Scale: 1:500 @A1 Rev



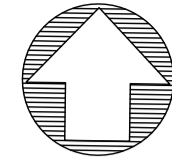

Jacobs No. B2494600

Drawing number  
**B2494600-CD-S6-02**

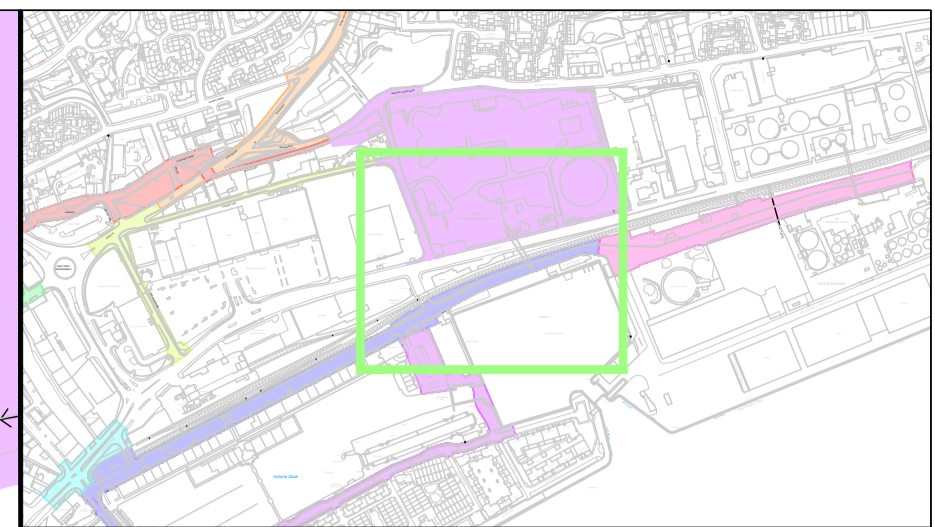

EDEN PROJECT DUNDEE



- Legend**
-  Proposed New Kerb Line
  -  Proposed New Footway (including traffic islands)
  -  Proposed New Carriageway (including removal of traffic islands)
  -  Proposed New Greenspace
  -  Proposed Segregated Cycle Lane



Rev	Rev Date	Purpose of revision	Des'd	Check'd	Rev'd	Appr'd

**Jacobs**  
 95 Bothwell St, Glasgow, G2 7HX  
 Tel: +44(0)141 243 8000 Fax: +44(0)141 226 3109  
 www.jacobs.com

Client  
**DUNDEE CITY COUNCIL**

Project  
**EDEN PROJECT DUNDEE TRAVEL CONNECTIONS**

Drawing title  
**SCHEME 6 WATERFRONT TO EDEN CONCEPT DESIGN FROM WEST SHEET 3 OF 3**

Drawing status  
**CONCEPT DESIGN**

Scale 1:500 @A1 Rev

Jacobs No. B2494600

Drawing number  
**B2494600-CD-S6-03**

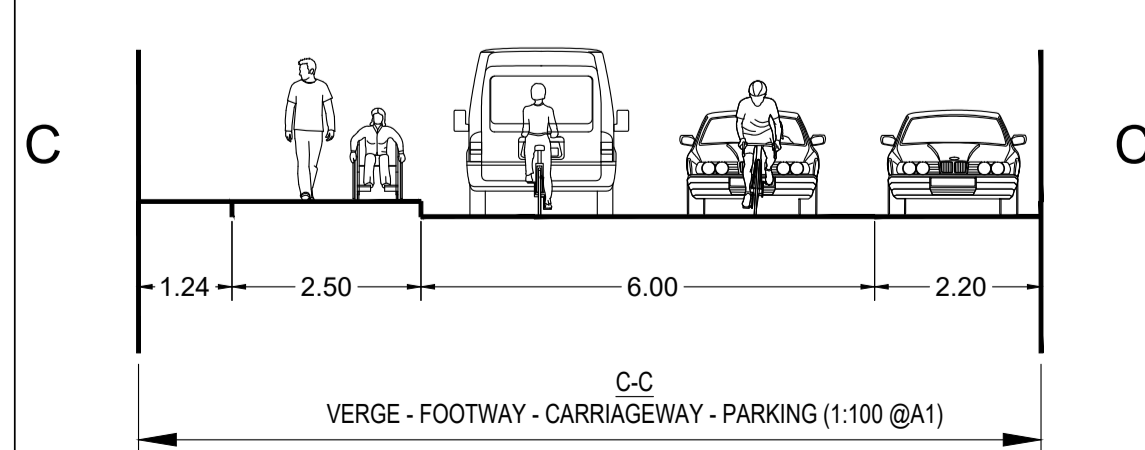

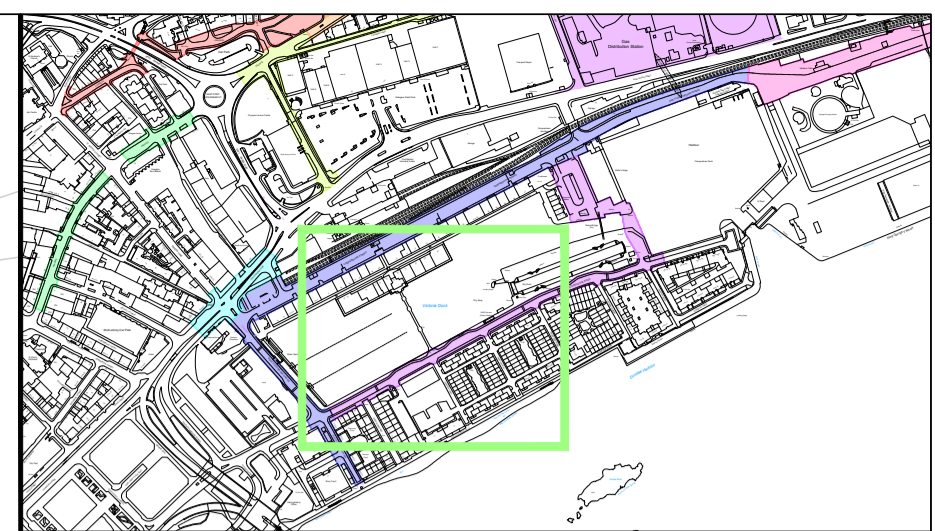

- Legend**
- Proposed New Kerb Line
  - Proposed New Footway (including traffic islands)
  - Proposed New Carriageway (including removal of traffic islands)
  - Proposed New Greenspace
  - Proposed Segregated Cycle Lane

Rev	Rev Date	Purpose of revision	Des'd	Check'd	Rev'd	Appr'd

**Jacobs**  
 95 Bothwell St, Glasgow, G2 7HX  
 Tel: +44(0)141 243 8000 Fax: +44(0)141 226 3109  
 www.jacobs.com

Client  
**DUNDEE CITY COUNCIL**

Project  
**EDEN PROJECT DUNDEE TRAVEL CONNECTIONS**

Drawing title  
**SCHEME 7 WATERFRONT TO EDEN CONCEPT DESIGN FROM SOUTH - SHEET 1 OF 2**

Drawing status  
 Scale: 1:500 @A1 Rev  
 Jacobs No. B2494600  
 Drawing number

**B2494600-CD-S7-01**

© Crown Copyright and database right 2025. All rights reserved. Ordnance Survey Licence number [INSERT NUMBER]

© Copyright 2025 Jacobs U.K. Limited. The concepts and information contained in this document are the property of Jacobs. Use or copying of this document in whole or in part without the written permission of Jacobs constitutes an infringement of copyright. Limitation: This drawing has been prepared on behalf of and for the exclusive use of Jacobs' Client, and is subject to, and issued in accordance with, the provisions of the contract between Jacobs and the Client. Jacobs accepts no liability or responsibility whatsoever for, or in respect of, any use of, or reliance upon, this drawing by any third party.

Garage

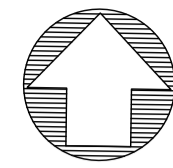

Harbour

Camperdown Dock



Legend

- Proposed New Kerb Line
- Proposed New Footway (including traffic islands)
- Proposed New Carriageway (including removal of traffic islands)
- Proposed New Greenspace
- Proposed Segregated Cycle Lane

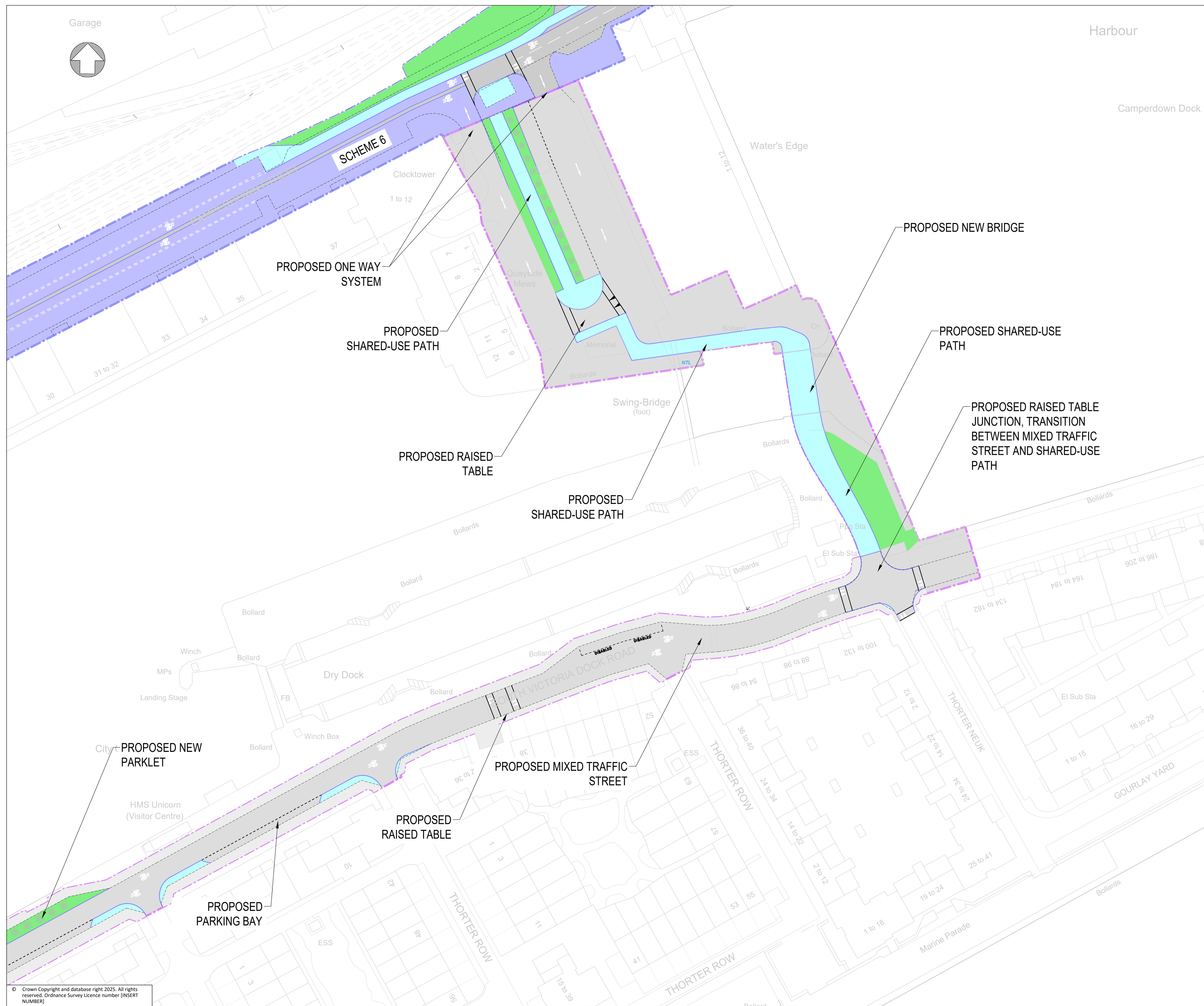

Rev	Rev Date	Purpose of revision	Des'd	Check'd	Rev'd	Apprv'd

**Jacobs**  
 95 Bothwell St, Glasgow, G2 7HX  
 Tel: +44(0)141 243 8000 Fax: +44(0)141 226 3109  
 www.jacobs.com

Client  
**DUNDEE CITY COUNCIL**

Project  
**EDEN PROJECT DUNDEE TRAVEL CONNECTIONS**

Drawing title  
**SCHEME 7 WATERFRONT TO EDEN CONCEPT DESIGN FROM SOUTH - SHEET 2 OF 2**

Drawing status  
 Scale: 1:500 @A1 Rev  
 Jacobs No. B2494600  
 Drawing number B2494600-CD-S7-02

© Crown Copyright and database right 2025. All rights reserved. Ordnance Survey Licence number [INSERT NUMBER]

© Copyright 2025 Jacobs U.K. Limited. The concepts and information contained in this document are the property of Jacobs. Use or copying of this document in whole or in part without the written permission of Jacobs constitutes an infringement of copyright. Limitation: This drawing has been prepared on behalf of and for the exclusive use of Jacobs' Client, and is subject to, and issued in accordance with, the provisions of the contract between Jacobs and the Client. Jacobs accepts no liability or responsibility whatsoever for, or in respect of, any use of, or reliance upon, this drawing by any third party.

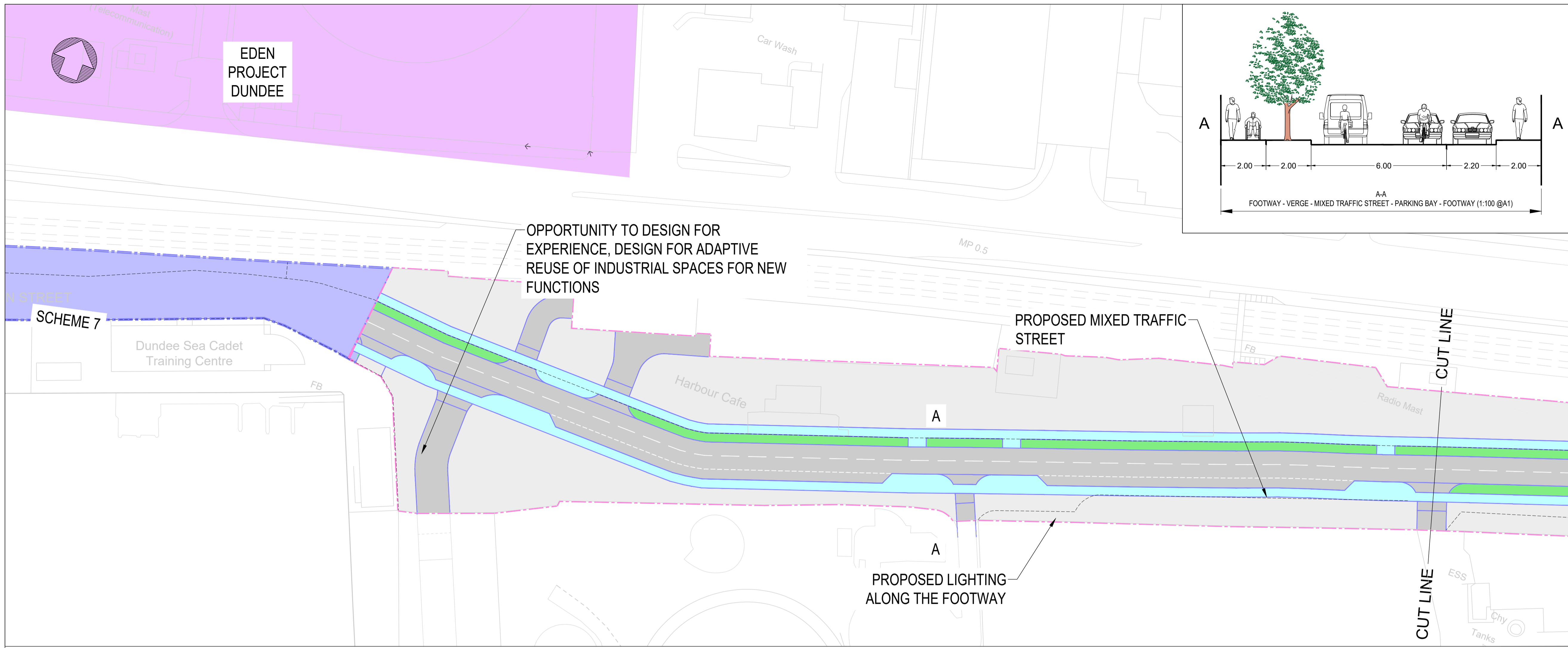

- Legend**
- Proposed New Kerb Line
  - Proposed New Footway (including traffic islands)
  - Proposed New Carriageway (including removal of traffic islands)
  - Proposed New Greenspace
  - Proposed Segregated Cycle Lane



Rev	Rev Date	Purpose of revision	Des'd	Check'd	Rev'd	Appr'd

**Jacobs**  
95 Bothwell St, Glasgow, G2 7HX  
Tel: +44(0)141 243 8000 Fax: +44(0)141 226 3109  
www.jacobs.com

Client  
**DUNDEE CITY COUNCIL**

Project  
**EDEN PROJECT DUNDEE TRAVEL CONNECTIONS**

Drawing title  
**SCHEME 8 EDEN TO STANNERGATE RBT CONCEPT DESIGN SHEET 1 OF 1**

Drawing status  
**FINAL CONCEPT**

Scale  
1:500 @A1 Rev

Jacobs No.  
B2494600

Drawing number  
B2494600-CD-S8-01