

Plan

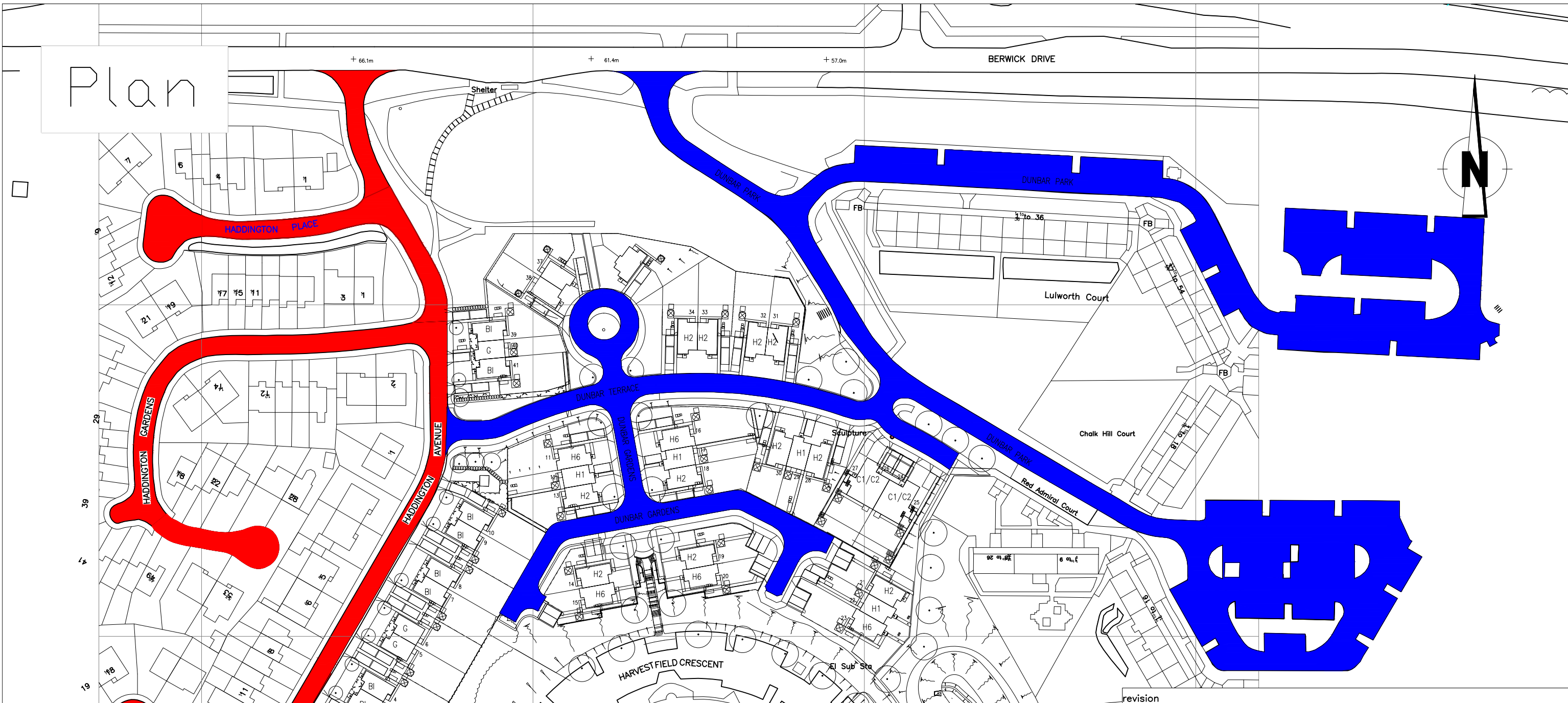

Legend



Existing Whifield '20mph Zone'



Proposed Extension to Whifield '20mph Zone'

revision					
Drawn	Checked	Drq.No.	Project No.	Scale	Date
S.S.	R.T.	1	T19.03.05	NTS	04.04.19.

Dundee City Council
 (Haddington Avenue Area)
 (Extension to 20mph Zone)
 Order 2019



City Development Department

City Development Department, Director Mike Galloway

Dundee House, 50 North Lindsay Street, Dundee DDI 1QE

Reproduced by permission of Ordnance Survey on behalf of HMSO. © Crown copyright and database right 2018. All rights reserved. Ordnance Survey Licence number 100023371.

Plan



Legend



Existing Whifield '20mph Zone'



Proposed Extension to Whifield '20mph Zone'

revision					
Drawn	Checked	Drq.No.	Project No.	Scale	Date
S.S.	R.T.	2	T19.03.05	NTS	04.04.19.

Dundee City Council
 (Haddington Avenue Area)
 (Extension to 20mph Zone)
 Order 2019



City Development Department

City Development Department. Director Mike Galloway

Dundee House, 50 North Lindsay Street, Dundee DD1 1QE

Reproduced by permission of Ordnance Survey on behalf of HMSO. © Crown copyright and database right 2018. All rights reserved. Ordnance Survey Licence number 100023371.

Ballumbie Primary School

Plan

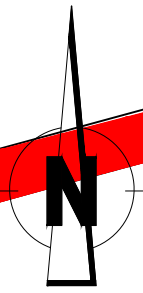

BRAEFIELD LANE

WHITFIELD LOAN

ETL

SUMMERFIELD TERRACE

BRAEFIELD TERRACE

BRAEFIELD GARDENS

KIRKCONNEL TERRACE

WHITFIELD TERRACE

SUMMERFIELD AVENUE

SUMMERFIELD GARDENS

Legend



Existing Whifield '20mph Zone'



Proposed Extension to Whifield '20mph Zone'

revision

Drawn	Checked	Drg.No.	Project No.	Scale	Date
S.S.	R.T.	3	T19.03.05	NTS	04.04.19.

Dundee City Council
(Haddington Avenue Area)
(Extension to 20mph Zone)
Order 2019



City Development Department

Reproduced by permission of Ordnance Survey on behalf of HMSO. © Crown copyright and database right 2018. All rights reserved. Ordnance Survey Licence number 100023371.

City Development Department. Director Mike Galloway

Dundee House, 50 North Lindsay Street, Dundee DD1 1QE