

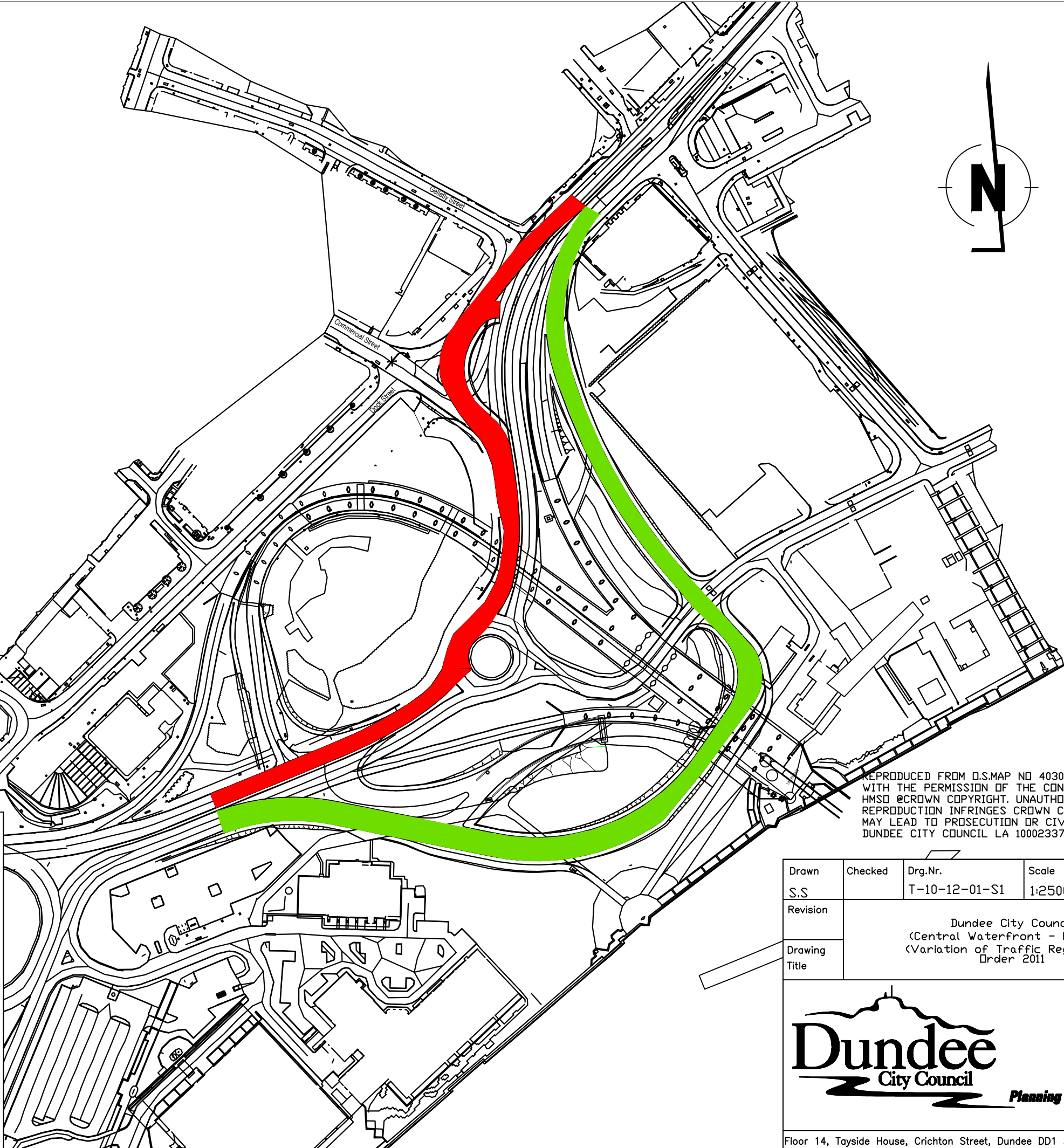

Plan

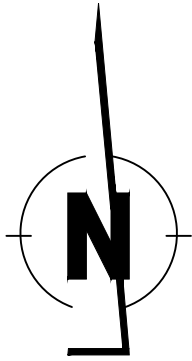

REPRODUCED FROM D.S.MAP NO 4030
 WITH THE PERMISSION OF THE CONTROLLER OF
 HMSO ©CROWN COPYRIGHT. UNAUTHORISED
 REPRODUCTION INFRINGES CROWN COPYRIGHT AND
 MAY LEAD TO PROSECUTION OR CIVIL PROCEEDINGS
 DUNDEE CITY COUNCIL LA 100023371

Legend

-  Proposed One-Way Traffic (Eastbound)
-  Proposed One-Way Traffic (Westbound)

Drawn	Checked	Drg.Nr.	Scale	Date
S.S		T-10-12-01-S1	1:2500	08.12.10
Revision				
Drawing Title	Dundee City Council (Central Waterfront - Phase II) (Variation of Traffic Regulations) Order 2011			



Plan

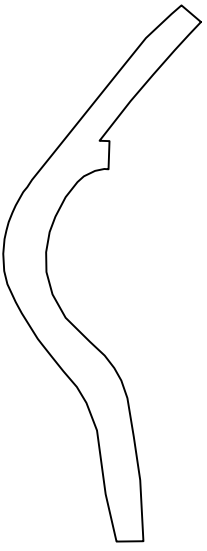
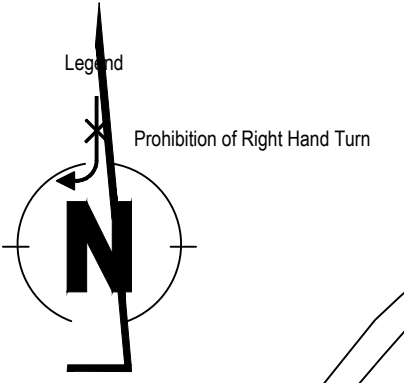
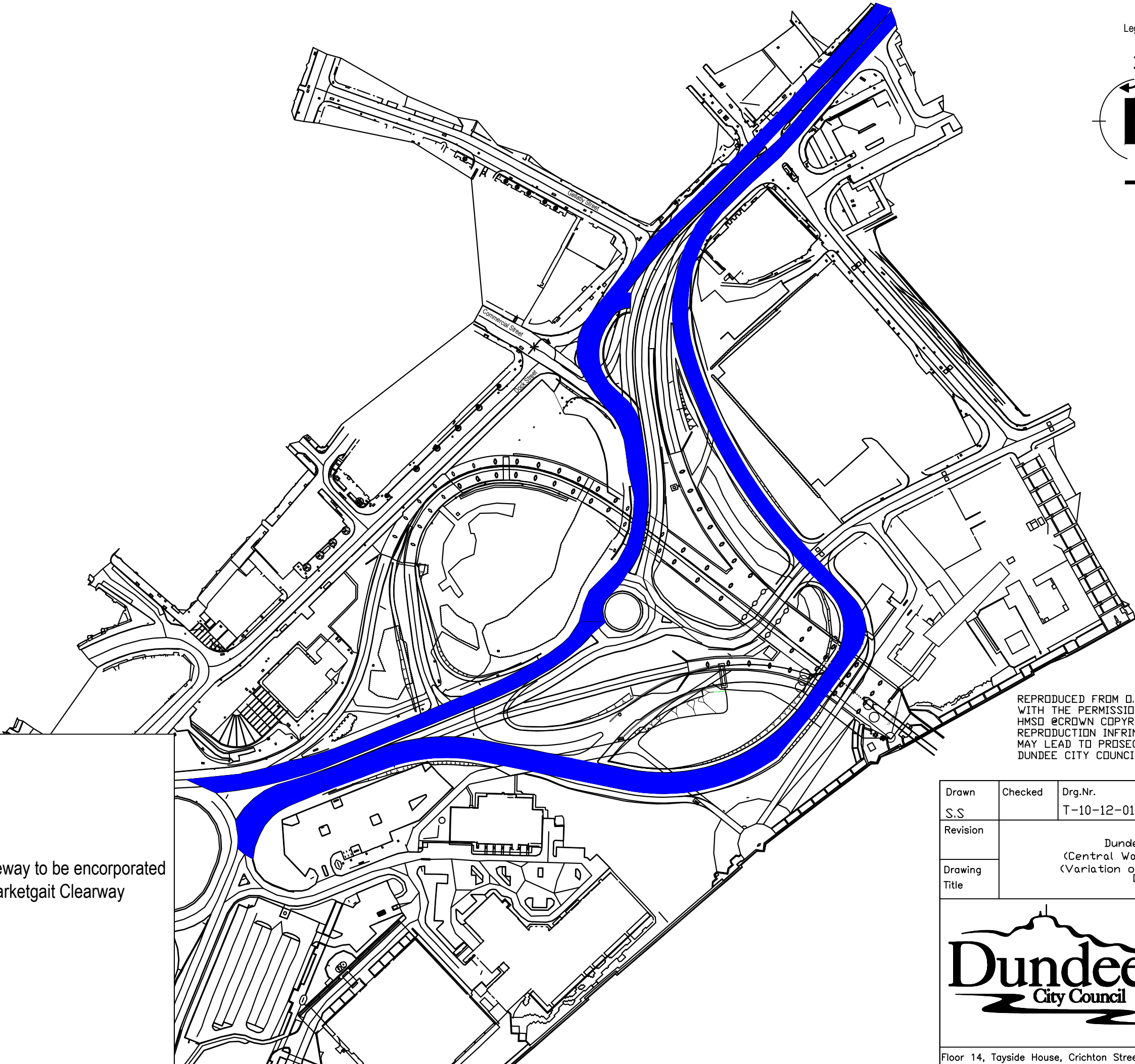

REPRODUCED FROM D.S.MAP NO 4030
 WITH THE PERMISSION OF THE CONTROLLER OF
 HMSO ©CROWN COPYRIGHT. UNAUTHORISED
 REPRODUCTION INFRINGES CROWN COPYRIGHT AND
 MAY LEAD TO PROSECUTION OR CIVIL PROCEEDINGS
 DUNDEE CITY COUNCIL LA 100023371

Legend



Sections of carriageway to be incorporated
 into the existing Marketgait Clearway
 Order

Drawn	Checked	Drg.Nr.	Scale	Date
S.S		T-10-12-01-S2	1:2500	08.12.10
Revision	Dundee City Council (Central Waterfront - Phase II) (Variation of Traffic Regulations) Order 2011			
Drawing Title				



Plan

Legend

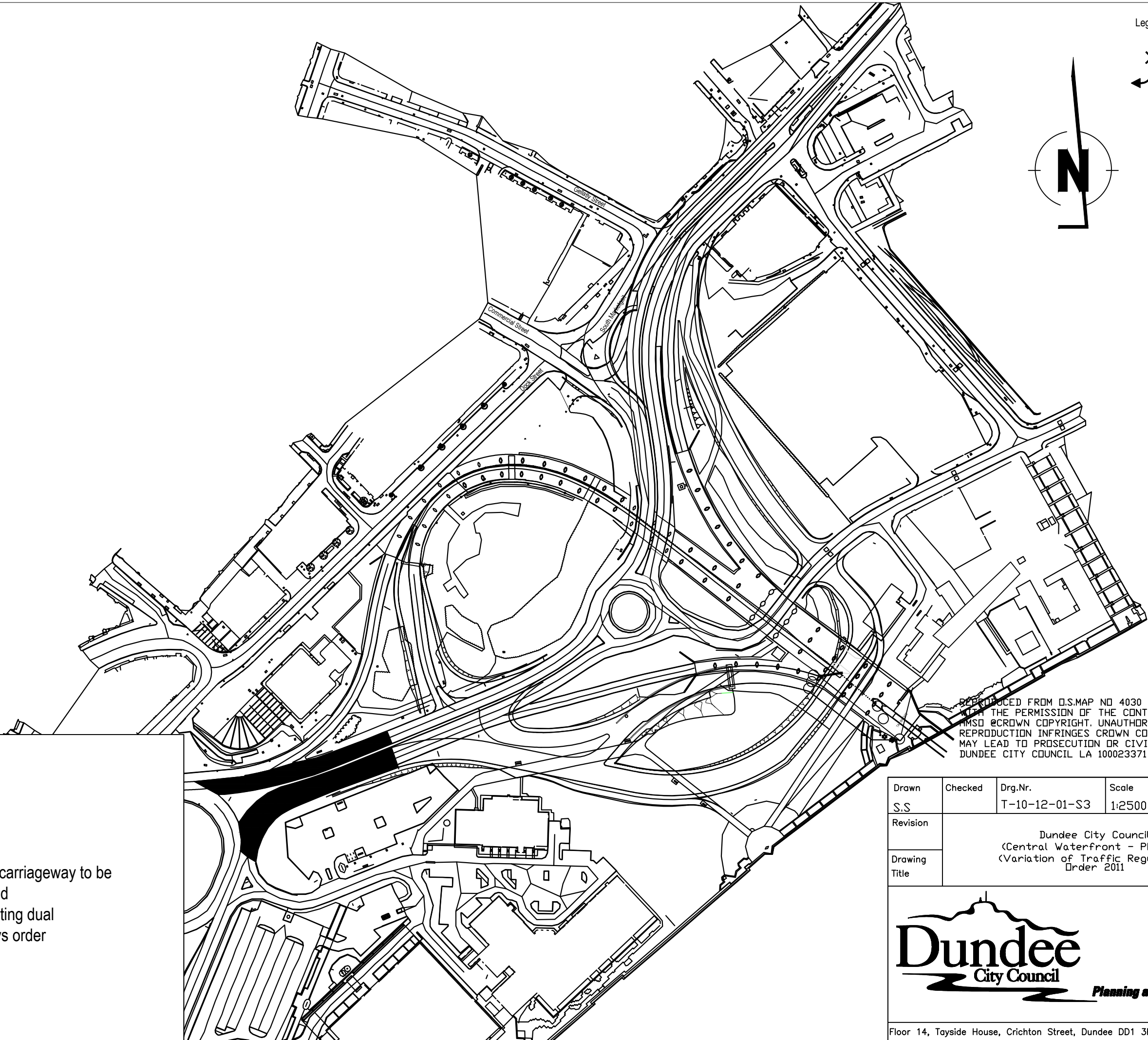
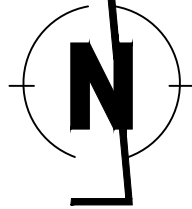

REPRODUCED FROM D.S.MAP NO 4030
 WITH THE PERMISSION OF THE CONTROLLER OF
 HMSO ©CROWN COPYRIGHT. UNAUTHORISED
 REPRODUCTION INFRINGES CROWN COPYRIGHT AND
 MAY LEAD TO PROSECUTION OR CIVIL PROCEEDINGS
 DUNDEE CITY COUNCIL LA 100023371

Legend



Sections of carriageway to be incorporated into the existing dual carriageways order

Drawn	Checked	Drg.Nr.	Scale	Date
S.S		T-10-12-01-S3	1:2500	08.12.10
Revision	Dundee City Council (Central Waterfront - Phase II) (Variation of Traffic Regulations) Order 2011			
Drawing Title				

